

**OREGON CORNER RESTORATION FORM**

Section 20  
County Umatilla

Township 3N  
Date: 02/17/10

Range 29E

Corner Designation: 3N29P7

Center 1/4 common to sections 17, T3NR29E.

- Condition Report Only
- Not Found
- Remonumented
- Unrecorded
- Surveyed In
- Referenced Out

**Previous Renewals / Surveys, etc.**

Originally Surveyed by N.H. Gates in 1859. He set a post in a mound of earth.  
Survey #-158-B set a Brass cap.

**Monuments and Accessories Found: (Condition and Source)**

A 2 1/2" Brass Cap 21" Below the surface.

**Diagram**

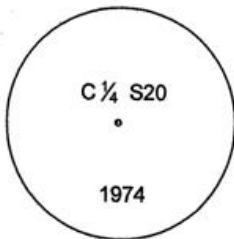

**Sketch**

Snow Road



NAD 83/91  
 OREGON STATE PLANE NORTH  
 INTERNATIONAL FEET  
  
 N753444.82  
 E8530193.53  
  
 LAT - 45° 43' 34.04459958" N  
 LON - 119° 12' 54.79288624" W

**Monument (s) Set (Procedures and Description)**

None.

**References Set:** "Deep One" magnets by Bernsten.

- A Pink magnet lies S 64°20' E, 16.08', 18" deep.
- A Silver Magnet lies N 42°00' E, 20.09', 18" deep.
- An Orange Magnet lies N 38°00' W, 18.20', 18" deep.
- A PK nail w/Brass Washer #43406 lies S 78°30' W, 32.03', on a Power Pole.

**Location and Comments**

The corner is 1.25 miles South of the intersection of Hwy 320 and Snow Road.

**Compass Declination**

17° E

**Surveyors Seal**

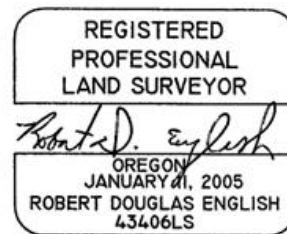

**RECEIVED BY:**

Date: 3-10  
 Rec'd By: KK  
 No. 10-34-R

**Firm / Agency**

Survey One, LLC.  
 P.O. Box 382  
 Pendleton, OR 97801  
 (541) 276-2055

RENEWAL DATE: 12/31/11