

OREGON CORNER RESTORATION FORM

Section 9

Township 3N

Range 29E

County Umatilla

Date: 09/08/09

Corner Designation: 3N29J13

Corner common to sections 9,10,15 and 16, T3NR29E.

- Condition Report Only
- Not Found
- Remonumented
- Unrecorded
- Surveyed In
- Referenced Out

Previous Renewals / Surveys, etc.

Originally Surveyed by N.H. Gates in 1859. He set a post in a mound of earth w/ charcoal. Staebler set a Brass Cap at position of found charred stake in survey H-4-B. D. Haddock found the Brass Cap set by Staebler.

Monuments and Accessories Found: (Condition and Source)

A 2.5" B.C.

A 3/8" Iron rebar w/rpc #852 under the fence lies N 89° 30' W, 71.00'.

A 3/8" Iron rebar w/rpc #852 under the fence lies S 00° 45' E, 61.77'.

A 3/8" Iron rebar w/rpc #852 under the fence lies S 01° 45' E, 32.04'.

A 3/8" Iron rebar w/rpc #852 under the fence lies N 89° 00' W, 35.48'.

Diagram

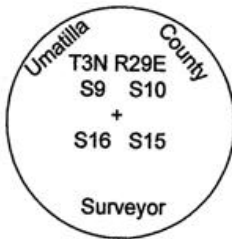

Sketch

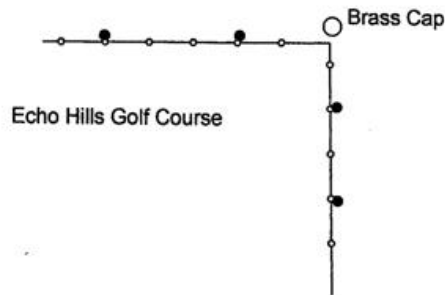

NAD 83/91
OREGON STATE PLANE NORTH
INTERNATIONAL FEET

N761550.58
E8538063.04

LAT - 45° 44' 52.81635" N
LON - 119° 11' 02.01980" W

Monument (s) Set (Procedures and Description)

None.

References Set:

None.

Location and Comments

The corner is located at the Northeast fence corner of the Echo Hills Golf Course.

Compass Declination

17° E

Surveyors Seal

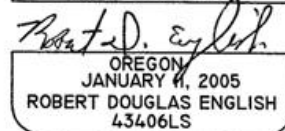
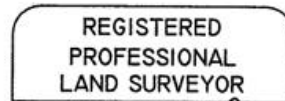

RENEWAL DATE: 12/31/09

RECEIVED BY:

Date: 1-11
 Rec'd By: KK
 No. 11-13-R

Firm / Agency

Survey One, LLC.
 P.O. Box 382
 Pendleton, OR 97801
 (541) 276-2055