

OREGON CORNER RESTORATION FORM

Section 4 Township 3N
County Umatilla Date: 08/31/09

Range 29E

Corner Designation: 3N29E11

1/4 Corner common to sections 4 and 9, T3NR29E.

- Condition Report Only
- Not Found
- Remonumented
- Unrecorded
- Surveyed In
- Referenced Out

Previous Renewals / Surveys, etc.

Originally Surveyed by N.H. Gates in 1859. He set a post in a mound of earth w/charcoal. Haddock set a 2 1/4" Brass cap on a 1 1/8" x 24" galvanized iron pipe 6" below the surface.

Monuments and Accessories Found: (Condition and Source)

- Found A 2 1/4" B.C.
- Found a 5/8" Iron rebar w/ypc #852 lies N 52°30' W, 24.20'.
- Found a 5/8" Iron rebar w/ypc #852 lies S 73°00' W, 20.19'.
- Found a 5/8" Iron rebar w/ypc #852 lies N 63°00' E, 20.33'.
- Found a 5/8" Iron pin SHRW for I-84, station 286+28, 165.00 left, lies S 21°00' E, 250.95'.

Diagram

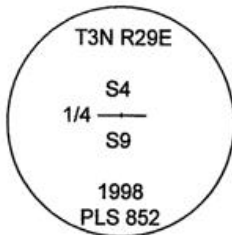

Sketch

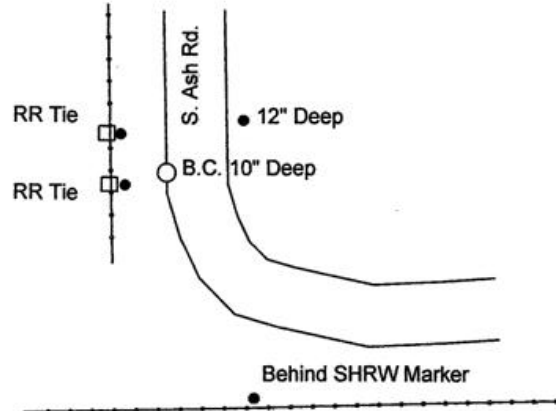

NAD 83/91
OREGON STATE PLANE NORTH
INTERNATIONAL FEET

N766784.06
E8535346.08

LAT - 45° 45' 44.91440" N
LON - 119° 11' 39.13665" W

Monument (s) Set (Procedures and Description)

None.

References Set:

None.

Location and Comments

The corner is .5 miles south of the intersection of Irwin Rd. and S. Ash Rd, on S. Ash Rd.

Compass Declination
17° E

Surveyors Seal

REGISTERED
PROFESSIONAL
LAND SURVEYOR

Robert D. English
 OREGON
 JANUARY 11, 2005
 ROBERT DOUGLAS ENGLISH
 43406LS

RENEWAL DATE: 12/31/09

RECEIVED BY:

Date: 1-11
 Rec'd By: RK
 No. 11-10-R

Firm / Agency

Survey One, LLC.
 P.O. Box 382
 Pendleton, OR 97801
 (541) 276-2055