

OREGON CORNER RESTORATION FORM

Section 33 Township 4N Range 29E

Z-11

County UMATILLA Date 3/95

CORNER DESIGNATION

5/4 Cor.

- Condition Report Only
- Not Found
- Renewed
- Unrecorded
- Surveyed In
- Referenced Out

Previous Renewals/Surveys, etc. ORIG SUR. BY GATES 1859 cont. #8A
He set post in mound

Monument(s) & Accessories Found: (Condition and Source)

Nothing Fnd.

Monument Detail

Sketch

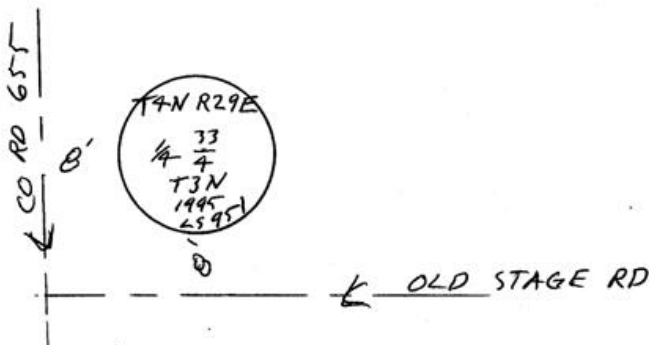

Monument Set (Procedures and Description)

By single proportion E-W & Judgment N-S
I set 1" x 30" I. Pipe with 2 3/8" B.C. stamped as above

SEE MY 1994-1 County Public Monumentation Sur.

New Accessories

- Alum tag stamped 951 in RR Tie F.P. Bears S 74° 17' 20" W 29.44 Ft.
- " " " in P. Pole " S 5° 21' 10" W 219.51 Ft.
- " " " in RR Tie F.P. " N 66° 56' 40" E 26.12 Ft.
- " " " in P. Pole Fence Post " S 76° 08' 28" E 121.91 Ft.

Location & Comments

@ Cor. CoRD #655
& OLD STAGE RD

Compass Declination _____

Firm/Agency EDWARDS

SURVEYING

Address P.O. Box 763

HERMISTON, OR 97038

Party Chief D. Edwards

Notes _____

Witness J. Coppock

Surveyor's Seal

REGISTERED
PROFESSIONAL
LAND SURVEYOR

J. Dennis Edwards

OREGON
JULY 16, 1971
G. DENNIS EDWARDS
951

RENEWS 12/31/95

RECEIVED BY _____

Umatilla County Surveyor _____

Date _____

Rec'd By _____

No. 95-60-B