

OREGON CORNER RESTORATION FORM

Section: 36 Township: 3N Range: 27E

V-25

County: Umatilla

Date: 5/90

CORNER DESEGATION

NE Corner

- Condition report only
- Not Found
- Renewed
- Unrecorded
- Surveyed in
- Referenced Out

Previous Renewals/Surveys, etc.: Orig. Survey platted and approved 12/31/1860. Otis O. Gould did a Dependent Resurvey in May 1940 in which he set a 2 1/2" brass cap on a 1 1/4" Iron Pipe and the same as a witness corner 45 lns west.

Monument(s) & Accessories Found; (Condition and Source)

29.70 feet West of the corner found 1 1/4" O.D. iron pipe with a 2 1/2" brass cap. 1940 legable.

Monument Detail



Sketch

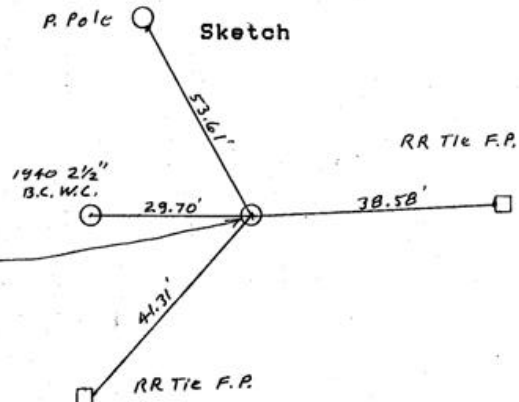

Monument Set (Procedures and Description): Set 1" by 30" Gal. iron pipe with 2 3/8" brass cap, stamped as above, 6" below the surface of a gravelled road.

New Accessories:

- from which
- Alum. tag in P pole bears N 27 49' W 53.61 feet
- Alum. tag in RR tie fence post bears N 88 25' E 38.58 feet
- Alum. tag in RR tie fence post bears S 42 56' 40" W 41.31 feet

Location & Comments: from the Jct. of Echo Hwy with Butter Cr. Hwy go West on gravel rd. 0.7 mile. Then go South on Gravel Rd. .5 mile to corner

Compass Dec. 18 Firm; Edwards Surveying P.O. Box 763, Hermiston, Oregon Party Chief; Denny Edwards Witness; J. Coppock

Surveyor's Seal

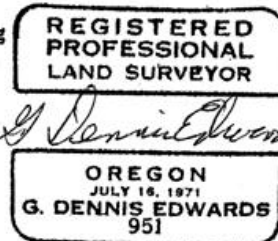

RECEIVED BY

Umatilla County Surveyor

Date 7-90

Rec'd By LA