

OREGON CORNER RESTORATION FORM

Section 18

Township 3N

Range 29E

County Umatilla

Date: 08/18/09

Corner Designation: 3N29N1

Corner common to section 13,24, T3NR28E, and section 18,19, T3NR29E. Condition Report Only

- Not Found
- Remonumented
- Unrecorded
- Surveyed In
- Referenced Out

Previous Renewals / Surveys, etc.

Originally Surveyed by N.H. Gates in 1859. He set a post in a mound of earth.

Survey I-157-B records finding a brass cap.

Condition report by D. Haddock 6/14/02 found brass capped monument 4" below surface.

Monuments and Accessories Found: (Condition and Source)

A 2.5" B.C.

A B.C. W.C. lies N 86°00' W, 45.56'.

Diagram

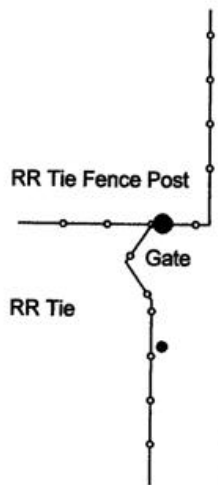
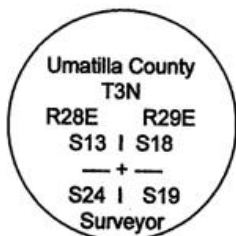

Sketch

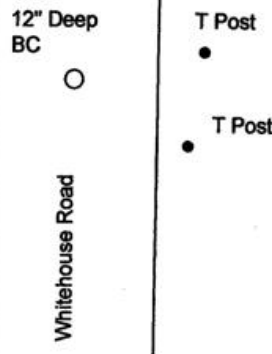

NAD 83/91
OREGON STATE PLANE NORTH
INTERNATIONAL FEET

N755835.65
E8521660.21

LAT - 45° 43' 58.9688166" N
LON - 119° 14' 54.547065" W

Monument (s) Set (Procedures and Description)

None.

References Set:

A 5/8" x 30" Iron rebar w/ypc #43406 lies S 39°45' E, 36.97'.

A 5/8" x 30" Iron rebar w/ypc #43406 lies N 87°00' E, 29.63'.

A 5/8" x 30" Iron rebar w/ypc #43406 lies S 48°00' W, 38.45'.

Location and Comments

The corner is .6 miles North of the intersection of Hwy. 320 and Whitehouse Rd.

Compass Declination

17° E

Surveyors Seal

REGISTERED
PROFESSIONAL
LAND SURVEYOR

Robert D. English

OREGON
JANUARY 11, 2005
ROBERT DOUGLAS ENGLISH
43406LS

RECEIVED BY:

Date: 10-09
Rec'd By: SE
No. 09-146R

Firm / Agency

Survey One, LLC.
P.O. Box 382
Pendleton, OR 97801
(541) 276-2055

RENEWAL DATE: 12/31/09