

OREGON CORNER RESTORATION FORM

COUNTY: Umatilla. DATE: 04/19/23.

CORNER DESIGNATION: L-9, the East Quarter Corner of Section 17, Township 3 North, Range 28 East, W.M.

PREVIOUS RENEWALS/SURVEYS ETC: Corner was originally established by N.H. Gates under Contract No. 84, dated July 22, 1859. Gates set a post in earth mound. Survey No. 357, found in Record of Private Survey Books shows a symbol for the corner, which is believed to be a square post set 18" in the ground in 1912. The corner area was surveyed through in Survey No. 84-56-B but no corner was established or monumented.

MONUMENT AND ACCESSORIES FOUND: None. I reestablished the corner point by single proportion measure between the Northeast and Southeast corners of Section 17.

MONUMENT MARKING DETAIL:

T3N R28E
1/4
S17 | S16
2023
PLS 54657

NEW MONUMENT SET:

At the position determined by survey set a 5/8" X 22" rebar with 2" aluminum cap with cap 10" below gravel road surface. I used a rebar monument because of painted marks indicating a buried power line. The aluminum cap is marked as shown in Monument Marking Detail. This corner falls 3.6' South of a line projected East from the West Quarter corner of Section 17, through position for the Center Quarter corner computed on Survey No. 00-33-B.

New accessories:

- A 5/8"X24" rebar with blue plastic cap marked "Wells Surveying 54657PLS" bears N 21°06'07" E, 106.91', 6" Southerly of a 10" metal bollard @ SW corner of large metal storage building. No bearing object sign.
- A 5/8"X24" rebar with blue plastic cap marked "Wells Surveying 54657PLS" bears S 60°40'17" E, 35.81'. Wired bearing object sign to rebar.
- A Blue Deep-1 magnet set 22" below ground line bears S 32°12'46" W, 37.85', buried 22" below ground line. Buried bearing object sign with the Deep-1 magnet.
- A 5/8"X24" rebar with blue plastic cap marked "Wells Surveying 54657PLS" bears N 22°42'52" W, 34.12', set 6" Southerly of a cut off power pole at SE corner of a UECA power vault. Attached witness sign and bearing object sign to the pole.

Courses to corner accessories are State Plane Grid bearings and distances.

LOCATION AND COMMENTS: The corner falls at the approximate intersection of the West edge of a North-South road with the South edge of an East-West road.

OREGON STATE PLANE COORDINATE, North Zone NAD 83(91), International Feet Units:

N: 758332.20
E: 8500419.90

FIRM: Wells Surveying
P.O. Box 1696
Pendleton, OR 97801

Surveyor's Seal

\3N28L-9

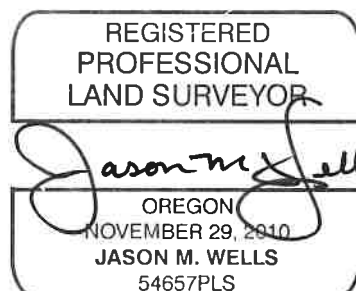

RENEWS: 6/30/24

24-004-C