

OREGON CORNER RESTORATION FORM

COUNTY: Umatilla. DATE: 03/16/23.

CORNER DESIGNATION: J-5, the Northwest Corner of Section 17, Township 3 North, Range 28 East, W.M.

PREVIOUS RENEWALS/SURVEYS ETC: Corner was originally established by N.H. Gates under Contract No. 84, dated July 22, 1859. Gates set a post in earth mound. Survey No. Q-506-A set a "Stake" for the Corner in a North South fence line. Survey No. 00-33-B recovered the burnt remains of a stake in a North-South fence line and remonumented with a brass cap on iron pipe monument.

MONUMENT AND ACCESSORIES FOUND: Found 2 1/2" brass cap monument iron pipe per Survey No. 00-33-B 4" flush with the ground in a North-South fence line. Brass cap is stamped as shown in Monument Marking Detail.

MONUMENT MARKING DETAIL:

T3N R28E
S7 | S8

S18 | S17
2000
PLS 852

MAINTAINED CORNER MONUMENT:

An existing rebar accessory bears N 01°07'43" W, 45.32', in N-S fence line.
An existing rebar accessory bears S 00°14'37" E, 44.32', in N-S fence line.
An existing rebar accessory bears S 00°25'34" W 177.39', 1' SW of UECA power pole.
Attached bearing object signs to the 3 existing rebar accessories. Courses to 3 existing accessories are true bearings and distances.

The rebar accessory near the center pivot wheel stop is missing. I set a new accessory, a 5/8X24" rebar with blue plastic cap marked "Wells Surveying 54657PLS bears N 55°13'28" W 172.88'. attached bearing object sign to rebar. The bearing to this accessory rebar is Oregon State Plane Grid Bearing.
The existing rebar accessories are as reported from Survey No. 00-33-B.

I set a steel fence post with witness post sign attached 1 foot North of brass cap monument.

LOCATION AND COMMENTS: The corner monument is located North of the North driveway to the George Sailing residence.

OREGON STATE PLANE COORDINATE, North Zone NAD 83(91), International Feet Units:

N: 760954.37
E: 8495083.68

FIRM: Wells Surveying
P.O. Box 1696
Pendleton, OR 97801

Surveyor's Seal

\3N28J-5

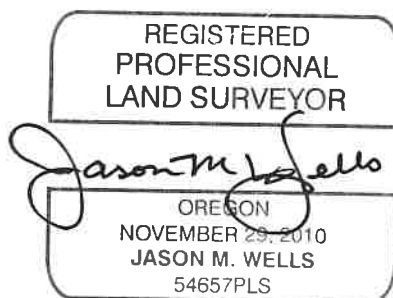

RENEWS: 6:30:24

24-004-C