

OREGON CORNER RESTORATION FORM

COUNTY: Umatilla. DATE: 04/05/23.

CORNER DESIGNATION: F-5, the North 1/16th corner common to Sections 7 & 8, Township 3 North, Range 28 East, W.M., was established and monumented as a reference to Corner G-5, The East Quarter corner of Section 7 which falls in a irrigated circle

PREVIOUS RENEWALS/SURVEYS ETC: Corner G-5, the East Quarter corner of Section 7, was originally established by N.H. Gates under Contract No. 84, dated July 22, 1859. Gates set a post in earth mound. Survey No. 240, in 1906, recorded in Record of Private Survey Books, declared the corner lost and reestablished and monumented with a stone monument. Survey No. 240 also established the North and South 1/16th corners common to Section 7 and 8 and monumented with stone monuments.

MONUMENT AND ACCESSORIES FOUND: None. The North 1/16th corner common to Sections 7 & 8 was established and monumented as a reference to Corner G-5. The 2" aluminum cap on the monumented 1/16th corner is stamped as shown in Monument Marking Detail.

MONUMENT MARKING DETAIL:

T3N R28E
N 1/16
S7 | S8
· 2023
PLS 54657

NEW MONUMENT SET:

At the position established by survey, set a 5/8"X30" rebar with 2" aluminum cap, 30" in the ground. Set steel fence post with Witness post sign 1' North of the monument.

New Accessories:

- A 5/8"X24" rebar with blue plastic cap marked "Wells Surveying 54657PLS bears N 69°14'50" E, 136.60', on road bank. Wired bearing object sign to the rebar.
- A 5/8"X24" rebar with blue plastic cap marked "Wells Surveying 54657PLS bears S 82°49'27" E, 160.63', between 2 pressurized water pipes crossing irrigation ditch. Wired bearing object sign to the rebar.
- A 5/8"X24" rebar with blue plastic cap marked "Wells Surveying 54657PLS bears S 04°03'16" W, 51.41'. Wired bearing object sign to the rebar.
- A 5/8"X24" rebar with blue plastic cap marked "Wells Surveying 54657PLS bears N 83°44'24" W, 68.34', beside lone sage bush. Wired bearing object sign to the rebar.

Courses to corner accessories are Oregon State Plane Grid bearings and distances.

LOCATION AND COMMENTS: The corner monument is located in sage covered prairie, 90'+- Westerly of West edge of irrigation ditch.

OREGON STATE PLANE COORDINATE, North Zone NAD 83(91), International Feet Units:

N: 763616.08
E: 8495019.06

FIRM: Wells Surveying
P.O. Box 1696
Pendleton, OR 97801

Surveyor's Seal

\3N28F-5

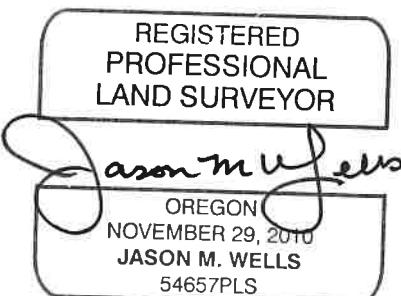

24-004-C

RENEWS: 6!30!24