

OREGON CORNER RESTORATION FORM

COUNTY: Umatilla. DATE: 02/28/23.

CORNER DESIGNATION: E-5, the Southeast Corner of Section 6, Township 3 North, Range 28 East, W.M.

PREVIOUS RENEWALS/SURVEYS ETC: Corner was originally established by N.H. Gates under Contract No. 84, dated July 22, 1859. Gates set a post in earth mound. Survey No. 240, found in Record of Private Survey Books, indicates the corner was recovered but does not identify a corner monument. Survey No. 408, found in Record of Private Survey Books, accepted a fence corner with fences N, S, E & W as the corner. Survey No. Q-503-B identifies a fence corner as the corner point. Survey No. S-14-B recovers a "stake" for the corner and remonuments with a 2 1/2" brass cap monument. Subsequent record surveys in the vicinity have used the brass cap monument per S-14-B as the corner.

MONUMENT AND ACCESSORIES FOUND: Found 2 1/2" brass cap monument from Survey No. S-14-B, 16" underground, 3' North of an East-West fence line. The brass cap is marked as shown in the Monument Marking Detail.

MONUMENT MARKING DETAIL:

T3N R28E
6|5
7|8
1981
PLS 1638

MAINTAINED CORNER MONUMENT:

From the existing brass cap monument:

New accessories:

- A 5/8"X24" rebar with blue plastic cap marked "Wells Surveying 54657PLS" bears S 88°07'09" E, 66.59'. Wired bearing object sign to the rebar.
- A 5/8"X24" rebar with blue plastic cap marked "Wells Surveying 54657PLS" bears S 84°51'30" E, 29.23'. Wired bearing object sign to the rebar.
- A 5/8"X24" rebar with blue plastic cap marked "Wells Surveying 54657PLS" bears S 61°09'24" E, 5.67'. Attached bearing object sign and witness post sign to 6" round wood fence post 8" NE of the rebar.
- A 5/8"X24" rebar with blue plastic cap marked "Wells Surveying 54657PLS" bears S 84°53'54" W, 34.93'. Wired bearing object sign to the rebar.

Courses to corner accessories are State Plane Grid bearings and distances.

LOCATION AND COMMENTS:

OREGON STATE PLANE COORDINATE, North Zone NAD 83(91), International Feet Units:

N: 766277.79
E: 8494954.45

FIRM: Wells Surveying
P.O. Box 1696
Pendleton, OR 97801

Surveyor's Seal

\3N28E-5

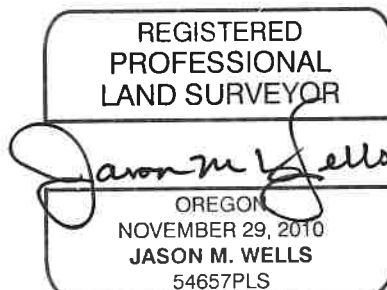

RENEWS: 6!30!24

24-004-C