

**OREGON CORNER RESTORATION FORM**

COUNTY: Umatilla. DATE: 03/06/23.

CORNER DESIGNATION: E-15, the North Quarter Corner of Section 10, Township 3 North, Range 28 East, W.M.

PREVIOUS RENEWALS/SURVEYS ETC: Corner was originally established by N.H. Gates under Contract No. 84, dated July 22, 1859. The corner was reestablished by single proportion measure on Survey No. S-14-B in 1981.

MONUMENT AND ACCESSORIES FOUND: Found 2 1/2" brass cap on pipe, at ground level, stamped as shown in Monument Marking Detail. The monument is at a fence corner with fences North, South and West. There is another fence corner 75 feet to the South with fences North, South and East.

MONUMENT MARKING DETAIL:

T3N R28E  
S3  
1/4 -----  
S10  
1981  
PLS 1638

MAINTAINED CORNER MONUMENT:

New accessories:

A 5/8"X24" rebar with blue plastic cap marked "Wells Surveying 54657PLS" bears S 44°11'06" E, 104.38', in East-West fence line. Wired bearing object sign to the rebar.

A 5/8"X24" rebar with blue plastic cap marked "Wells Surveying 54657PLS" bears S 01°50'25" E, 39.25', in North-South fence line. Wired bearing object sign to rebar.

A 5/8"X24" rebar with blue plastic cap marked "Wells Surveying 54657PLS" bears N 01°18'44" E, 25.96', in North-South fence line, 6" North of wood post. Nailed bearing object sign to wood post.

A 5/8"X24" rebar with blue plastic cap marked "Wells Surveying 54657PLS" bears N 00°06'22" W, 76.16', 6' South of round wood post in North-South fence line. Nailed bearing object sign to wood post.

Attached witness post sign to railroad tie post just North of corner.

Courses to corner accessories are State Plane Grid bearings and distances.

LOCATION AND COMMENTS:

OREGON STATE PLANE COORDINATE, North Zone NAD 83(91), International Feet Units:

N: 766339.57

E: 8508176.66

FIRM: Wells Surveying  
P.O. Box 1696  
Pendleton, OR 97801

Surveyor's Seal

\3N28E-15

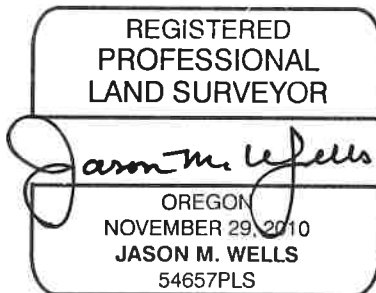

RENEWS: 6!30!24

24-004-C