

OREGON CORNER RESTORATION FORM

COUNTY: Umatilla. DATE: 02/15/23.

CORNER DESIGNATION: C-13, the East Quarter Corner of Section 4, Township 3 North, Range 28 East, W.M.

PREVIOUS RENEWALS/SURVEYS ETC: Corner was originally established by N.H. Gates under Contract No. 84, dated July 22, 1859. Gates set a post in earth mound. The corner was reestablished by single proportion measurement on Survey No. S-14-B, in 1981. Dave Haddock, on Corner Record 02-185-G, in 2002, reported finding a galv. iron pipe with rivet for the corner. That pipe position is S 89°40' E 43.6', from the brass cap monument found and tied on this survey. The pipe found by Dave Haddock is completely bent over and unusable.

MONUMENT AND ACCESSORIES FOUND: Found 2 1/2" brass cap on pipe, 4" below ground level, stamped as shown in Monument Marking Detail.

MONUMENT MARKING DETAIL:

T3N R28E
1/4
S4|S3
1981
PLS 1638

MAINTAINED CORNER MONUMENT:

New accessories:

- A 5/8"X24" rebar with blue plastic cap marked "Wells Surveying 54657PLS" bears S 88°22'25" E, 89.92', at railroad tie in East-West running corral fence. Nailed bearing object sign to railroad tie.
 - A 5/8"X24" rebar with blue plastic cap marked "Wells Surveying 54657PLS" bears S 88°06'16" E, 57.82', at railroad tie in East-West running corral fence. Nailed bearing object sign to railroad tie.
 - A 5/8"X24" rebar with blue plastic cap marked "Wells Surveying 54657PLS" bears N 51°36'44" E, 42.88', at 6" round wood post in North running fence line. Nailed bearing object sign to wood post.
 - A 5/8"X24" rebar with blue plastic cap marked "Wells Surveying 54657PLS" bears N 29°15'29" E, 67.96', at 6" round wood post in North running fence line. Nailed bearing object sign to wood post.
- Attached Witness Post sign to railroad tie corral fence end post, 2'+/- South of and 3'+/- West of monument.

Courses to corner accessories are State Plane Grid bearings and distances.

LOCATION AND COMMENTS: Corner is located 2'+/- North of and 3'+/- East of a railroad tie fence end post for a corral area South of the fence line which runs East.

OREGON STATE PLANE COORDINATE, North Zone NAD 83(91), International Feet Units:

N: 769062.93
E: 8505479.41

FIRM: Wells Surveying
P.O. Box 1696
Pendleton, OR 97801

Surveyor's Seal

\3N28C-13

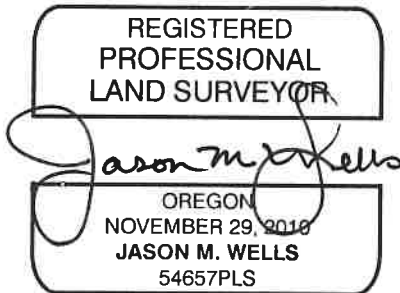

RENEWS: 6/30/24

24-004-C