

OREGON CORNER RESTORATION FORM

Section 12 Township 3N Range 27E
 County Umatilla Date 06-30-02

Corner Designation: 3N27J29

Condition Report Only
 Not Found
 Remonumented
 Unrecorded
 Surveyed In
 Referenced Out

Previous Renewals / Surveys, etc.

Survey 90-49-B records finding this monument set by Gould in 1940.

Monument and Accessories Found: (condition and source)

Found a brass capped monument stamped as shown in the diagram.

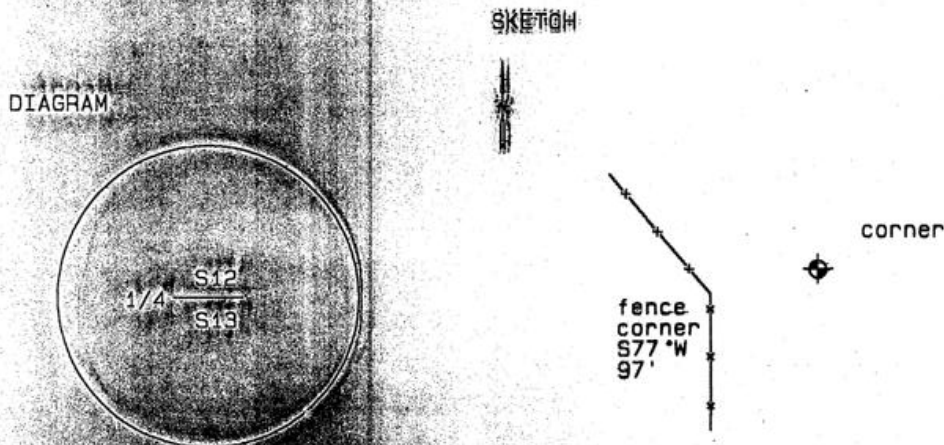

MONUMENT (S) AND ACCESSORIES SET (Procedures and Description)

None.

REFERENCES SET

None.

Made GPS tie to TBM Station
 Stanfield East Base
 Latitude 45° 44' 34" S 125° 00' 00" W
 Longitude 119° 22' 58" W 11556' W
 NAD 83 (1994)

Oregon State Plane Coord. - North Zone
 Northing 760940.47
 Easting 8487287.12
 Ortho Height 741.38
 Ellipsoidal Height 671.57

Location and Comments

Compass Declination
 20°E

Surveyors Seal

From junction of 164 and Westland Road, go south on Jordan Road 4.1 miles. Then follow the Madison Farm Roads through the corners in a generally southern direction for 2.2 miles to corner 3N27J29. Then go west uphill 0.5 miles to corner.

REGISTERED
 PROFESSIONAL
 LAND SURVEYOR

RECEIVED BY:

Firm / Agency

David L. Haddock

Date: 12-02
 Rec'd By: KE
 No: 02-282-9

Haddock Surveying
 P. O. Box 1874
 Pendleton, OR 97801
 (541) 876-2174

OREGON
 JULY 12, 1968
 DAVID L. HADDOCK
 852

RENEWS 6-30-03