

OREGON CORNER RESTORATION FORM

Section 32 Township 2S Range 33E
 County Umatilla Date: June 20, 2000

Corner Designation: 2S33Z7

South Quarter corner to section 32, T2S, R33E,
 W.M., Umatilla County, Oregon.

Condition Report Only
 Not found
 Remonumented
 Unrecorded
 Surveyed in
 Referenced out

Previous Renewals / Surveys, etc.

The original survey by John C. Arnold under contract No. 551 dated March 19, 1890 shows this corner on the plat only. The line was not run and no monument was set.

Monument and Accessories found: (condition and source)
 None.

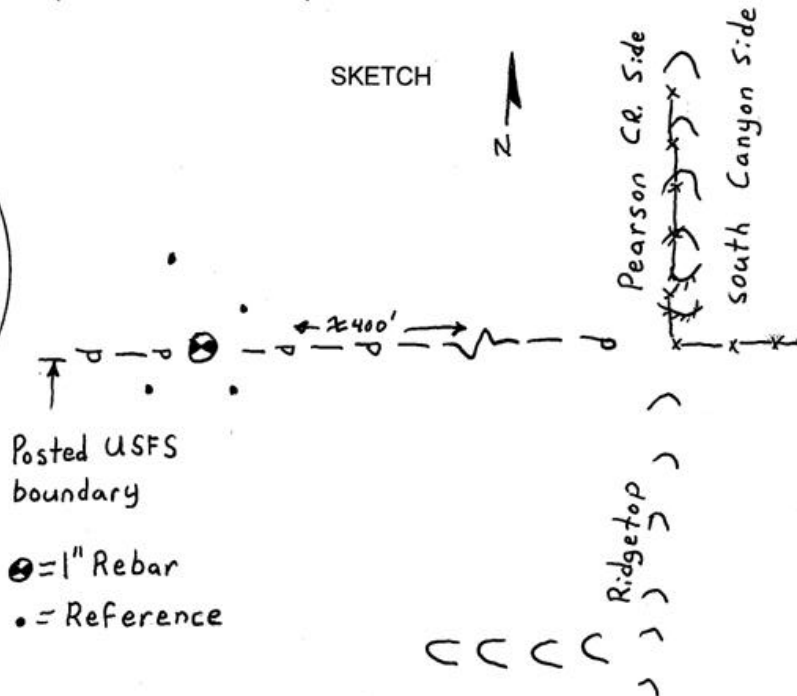
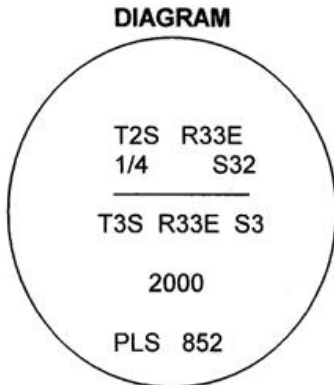

MONUMENT (S) AND ACCESSORIES SET (Procedures and Description)

Set a 1" x 24" Iron rebar with a 2" aluminum cap stamped as shown in the diagram above on the township line as established by the senior corners east and west at the proportionate distance between the closing corners for section 32.

For references, I set four 5/8" by 24" rebars with 2.5" red plastic caps stamped ORLS 852, WALSH 13922 and HADDOCK SURVEYING as described below:

- an iron rebar bears N30°55'02"W, 70.59 feet;
- an iron rebar bears N29°24'35"E, 33.92 feet;
- an iron rebar bears S37°28'28"E, 22.40 feet;
- an iron rebar bears S61°22'38"W, 40.22 feet;

The monument and references were tied using a LIECA SYSTEM 300 RTK GPS.

Location and comments

Compass Declination

Surveyors Seal

RECEIVED BY:
 Umatilla County Surveyor
 Date: 7-20
 Rec'd By: KK
 No. 00-156-B

Firm / Agency
 Haddock Surveying
 Address
 P.O. Box 1574
 Pendleton, Or. 97801
 Party Chief
 Stephen K, Haddock

REGISTERED
 PROFESSIONAL
 LAND SURVEYOR

David L. Haddock

OREGON
 JULY 12, 1988
 DAVID L. HADDOCK
 852