

**CERTIFIED RECORD OF LAND CORNER MONUMENTATION**

Index File No. Z-5

**History of original corner establishment:** In 1890, under G.L.O. Contract No. 551, John C. Arnold set a basalt stone 18x10x6 ins. 6 ins. in ground (digging imprac.) for closing corner to Secs. 31 & 32. Marked 5 notches on E. Cor., 1 notch on W. Face and C.C. on N. Face; raised mound of stone 1½ ft. H. x 3½ Ft. B. over Cor. which is 3 Ft. S. of a loose rock of the weight of about 1,000 lbs., from which corner A Fir 24 ins. diam. bears N80°E, 74 lks. dist. marked T2S R33E S32 BT. - A Fir 6 ins. Dia. bears N72°W, 200 lks. dist. marked T2S R33E S31 BT.

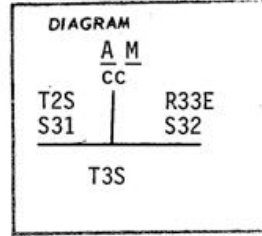

**Description of corner evidence found:** At corner position found mound of stone 1'x3' dia Could not find original stone. Found Douglas Fir 31" dia. for N.E. BT with visible scribing "R33E". The dist. to the old BT from the center of the stone mound is 48.8 ft = 74 lks.

This corner was set by a Junior Survey as a closing corner. It does not fall on true line so is stamped A M for amended cor. and the true intersection point is monumented.

**Description of monument and accessories established to perpetuate the original location of this corner** At center of stone mound:  
Set 2½"x30" Galvanized Pipe with brass cap stamped:  
Set pipe 20" in ground with mound of stone to cap.

BEARING OLD: Live Douglas Fir 31" dia. bears N70°E, 48.8 ft. with open blaze and visible scribing "R33E".  
TREES: NEW: A Douglas Fir 12" dia. bears N39°W, 48.0 ft., scribed T2S R33E S31 CC BT.

A M	
CC	
T2S	R33E
S31	S32
S3	
T3S	
1980	
OR PLS 1294	

Attached 54-3 & 54-4 signs to all BTs. Attached brass washer stamped LS 1294 to foot blaze of New BTs. Painted blazes and 6" band around all BTs. Attached 54-4 sign to metal post 5' west of corner.

I hereby certify the above corner monument was established as herein described on June 30, 1980.

Witnesses: R. Orton  
L. Huntsman  
D. Allen

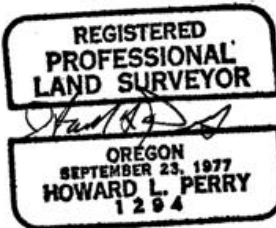

Office of County Surveyor County of Umatilla  
State of Oregon, I hereby certify that the within instrument was filed in this office for record on the December day of 1980,  
Daniel Krumbein by B. Platt  
(COUNTY OFFICIAL) (DEPUTY)

R-188-B

CERTIFIED RECORD OF LAND CORNER MONUMENTATION

Index File No. Z-5

History of original corner establishment:

In 1890, under G.L.O. Contract No. 551, John C. Arnold set a basalt stone 18x10x6 ins., 6 ins. in ground (digging imprac.) for closing corner to secs. 31 & 32. Marked 5 notches on E. cor, 1 notch on W. face and C.C. on N. Face: Raised mound of stone 1 1/2 ft H. x 3 1/2 ft. B. over cor. which is 3 ft S. of a loose rock of the weight of about 1,000 lbs, from which corner a Fir 24 ins. diam. bears N80°E, 74 lks. dist. Marked T2S R33E S32 BT. - a fir 6 ins. dia. Bears N72°W 200 lks dist. Marked T2S R33E S31 BT.

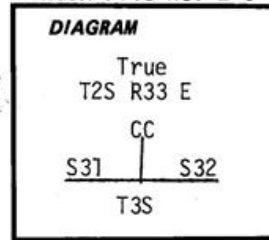

Description of corner evidence found:

At corner position found mound of stone 1'x3' dia. could not find original stone. Found Douglas fir 31" dia for N.E. BT with visible scribing "R33E." The dist. to the old BT from the center of the stone mound is 48.8 ft = 74 lks. This original corner position does not fall at the True intersection point. The original corner position was monumented and 7100-S7 made for it and stamped AM for amended corner.

Description of monument and accessories I established to perpetuate the original location of this corner:

At True intersection point set 2 1/2"x30" galvanized pipe with brass cap stamped:

Set pipe 20" in ground with mound of stone to cap.

T2S R33 E  
CC  
S31      S32  
S3  
T3S R33 E  
1980  
OR PLS 1294

Bearing Trees:

Old: A Doug. Fir 31" dia. bears N60°E 52.4 ft, scribed  
T2S R33E S32 CC BT.

New: A Doug. Fir 12" dia. bear. N25°W 68.3 ft, scribed  
T2S R33E S31 CC BT.

Attached 54-3 & 54-4 signs to all BT's. Attached brass washer stamped LS1294 to foot blaze of new BT's. Painted blazes and 6" band around all BT's. The 54-3 signs have True marked on them. Attached 54-2 & 54-4 signs to metal post 5' west of corner.

I hereby certify the above corner monument was established as herein described on August 18, 1980.

Witnesses: R. Orton  
G. Wagoner  
G. Lester  
J. Anderson



Office of..... County Surveyor..... County of..... Umatilla  
State of..... Oregon..... I hereby certify that the within instrument was filed in this office  
for record on the..... day of..... December..... 19.80  
*David Krumbein*..... by..... *Betty Skatts*  
(COUNTY OFFICIAL)..... (DEPUTY)