

USDA-FOREST SERVICE

Index

File No. Z-(1-2)

T 2S R. 33E

Merid. Willamette

CORNER RECORD (SEARCH)

(Ref. FSM 7151.4)

Tract or

Survey No. \_\_\_\_\_

Cor. 1

No. 16 120

R.D. Ukiah County Umatilla

N.F. Umatilla State Oregon

CORNER DIAGRAM

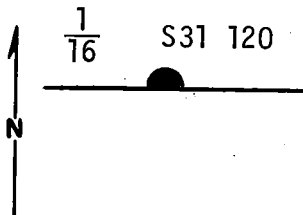

DESCRIBE CORNER MONUMENT FOUND

No corner was originally set.

DESCRIBE BEARING TREES OR OTHER OFFICIAL ACCESSORIES FOUND

PHOTO IDENTIFICATION DATA

Photo No. \_\_\_\_\_

Filed At. \_\_\_\_\_

Object Ident. \_\_\_\_\_

Ident. By \_\_\_\_\_

*Signature*

PLANE COORDINATE POSITION DATA

State \_\_\_\_\_ Zone \_\_\_\_\_

X \_\_\_\_\_

Y \_\_\_\_\_

Estab. By \_\_\_\_\_

*Agency*

DESCRIBE CORNER LOCATION RELATIVE TO NEAR-BY FEATURES, ALSO HOW TO REACH CORNER

Corner falls on a steep east slope on a bald hillside.

*Signature*  
*Howard R. ...*

Title

Division

Headquarters

Date

ORLS

1294

9-77

7100-52-(3/68)

**CORNER RECORD (PERPETUATION)**

**MONUMENT : DESCRIBE NEW MONUMENT SET, OR WORK DONE TO PRESERVE EXISTING MONUMENT**

At surveyed point set 2 1/2"x30" galvanized pipe with brass cap stamped:

T2S R33E  
 $\frac{1}{16}$  S31 120  

---

T3S  
1980  
OR PLS 1294

Set pipe 15" in ground with mound of stone to cap.

**ACCESSORIES : DESCRIBE NEW BT'S WITNESS OBJECTS ETC. ESTABLISHED, OR WORK DONE TO PRESERVE EXISTING EVIDENCE**

Bearing Trees:

A Ponderosa Pine 20" dia. bears N76°E 267.6 ft, scribed 1/16' 120 S31 BT.

A Douglas Fir 10" dia. bears N32°W 160.1 ft, scribed 1/16' 120 S31 BT.

Attached 54-3 & 54-4 signs to both BT's. Attached brass washer stamped LS1294 to foot blaze of both BT's. Painted blazes and 6" band around both BT's Red.

Attached 54-2 & 54-4 signs to metal post 5' east of corner. Attached 54-2 & 54-9 signs to metal post 5' north of corner.

Work Done By R. C. Orton Title Party Chief Date 8-22-86 State Registration No. \_\_\_\_\_  
or Agency \_\_\_\_\_

Certified Cor. Record Prepared? (Yes)  No  Filed At: \_\_\_\_\_ Date \_\_\_\_\_

Witnesses:	R. Orgon	REMARKS
	G. Wagoner	
	G. Lester	
	J. Anderson	

Index File No.	T.	R.	M.	Tract or Surv. No.	Cor.
<u>2-1-120</u>	<u>25</u>	<u>33E</u>			