

CERTIFIED RECORD OF LAND CORNER MONUMENTATION

INDEX FILE NO. W-(1-2)

History of original corner establishment:

No corner was originally set.

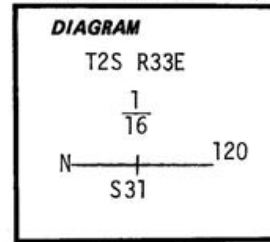

Description of corner evidence found:

Description of monument and accessories I established to perpetuate the original location of this corner:

At surveyed point set 2 1/2"x30" galvanized pipe with brass cap stamped:

Set pipe 24" in ground with mound of stone to cap.

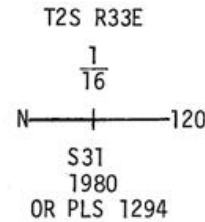

Bearing Trees:

A Ponderosa 12" dia. bears S9°W 22.8 ft, scribed N 1/16 120 S31 BT.

A Ponderosa Pine 15" dia. bears N87°W 66.0 ft, scribed N 1/16 120 S31 BT.

Attached 54-3 & 54-4 signs to both BT's. Attached brass washer stamped LS1294 to foot blaze of both BT's. Painted blazes and 6" band around both BT's Red. Attached 54-2 & 54-4 signs to metal post 5' south of corner. Attached 54-2 & 54-9 signs to metal post 5' west of corner.

I hereby certify the above corner monument was established as herein described on August 26, 1980.

Witnesses: R. Orton  
G. Wagoner  
G. Lester  
J. Anderson

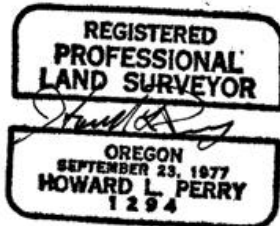

Office of..... County Surveyor..... County of..... Umatilla  
State of..... Oregon....., I hereby certify that the within instrument was filed in this office  
for record on the..... day of..... December....., 19..... 80  
*David D. Kumberson*..... by *Betty Shatto*  
(COUNTY OFFICIAL)..... (DEPUTY)