

OREGON CORNER RESTORATION FORM

Section 28 Township 2S Range 33E
 County Umatilla Date: June 20, 2000

Corner Designation: 2S33V11

Quarter corner to sections 28 and 33, T2S, R33E,
 W.M., Umatilla County, Oregon.

Condition Report Only
 Not found
 Remonumented
 Unrecorded
 Surveyed in
 Referenced out

Previous Renewals / Surveys, etc.

Corner originally set by John C. Arnold under contract No. 551 dated March 19, 1890.

His record reads: Set basalt stone 16 x 10 x 6 ins., 8 ins. in ground for 1/4 sec. cor., marked 1/4 on N. face. Raised mound of stone 2 ft. high x 3 1/2 ft base over stone on W. hillside, about 2 chs. W of rock ledge.

Monument and Accessories found: (condition and source)
 None.

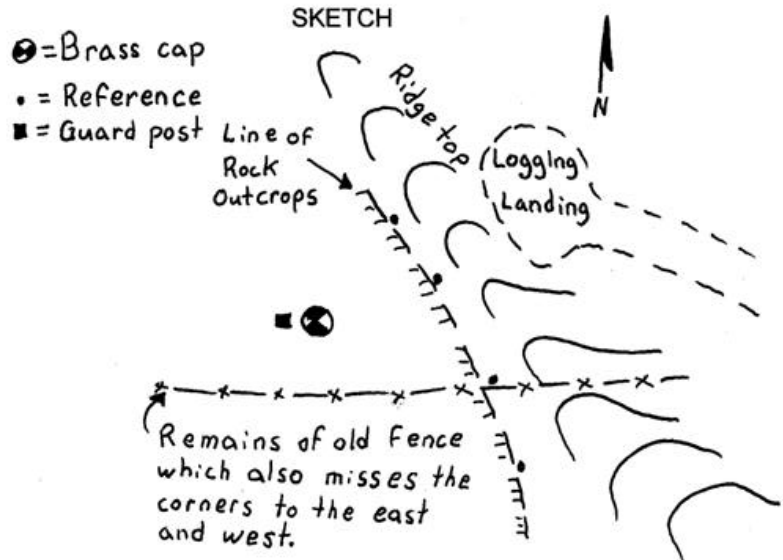
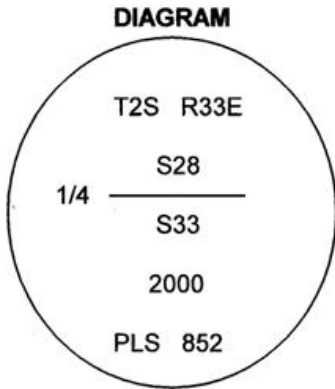

MONUMENT (S) AND ACCESSORIES SET (Procedures and Description)

Set a 1 1/2" x 30" galvanized iron pipe with a 2 1/4" brass cap stamped as shown in the diagram proportionate point. Set a 6' steel post with a county monument sign attached along side.

For references, I set four 5/8" by 24" rebars with 2.5" red plastic caps stamped ORLS 852, WAL 13922 and HADDOCK SURVEYING as described below:

- an iron rebar bears N32°43'09"E, 128.82 feet in a small rock ledge;
- an iron rebar bears N71°57'05"E, 93.97 feet in a small rock ledge;
- an iron rebar bears S74°08'59"E, 109.50 feet in a small rock ledge;
- an iron rebar bears S55°20'09"E, 116.41 feet in a small rock ledge;

The monument and references were tied using a LIECA SYSTEM 300 RTK GPS.

Location and comments

Compass Declination

Surveyors Seal

RECEIVED BY:
 Umatilla County Surveyor
 Date: 7-20
 Rec'd By: KK
 No. 00-156-C

Firm / Agency
 Haddock Surveying
 Address
 P.O. Box 1574
 Pendleton, Or. 97801
 Party Chief
 Stephen K, Haddock

REGISTERED
 PROFESSIONAL
 LAND SURVEYOR
David L. Haddock
 OREGON
 JULY 12, 1968
 DAVID L. HADDOCK
 852