

OREGON CORNER RESTORATION FORM

Section 24 Township 2S Range 33E
 County Umatilla Date: April 21, 2000

Corner Designation: 2S33R25

East corner to sections 24 and 25, T2S, R33E,
 W.M., Umatilla County, Oregon.

Condition Report Only
 Not found
 Remonumented
 Unrecorded
 Surveyed in
 Referenced out

Previous Renewals / Surveys, etc.

Corner originally set by James P. Currin and James E. Noland under special contract dated May 4, 1887. Their record reads: Set stone, 12 x 10 x 6 ins., 8 ins. in ground for corner to sections 19, 24, 25, and 30, marked with 2 notches on S. and 4 on N. edges. Raised a mound of stone around it.

References to Range 34 East were obliterated and the letters UR added for the Reservation Boundary under the same contract.

Monument and Accessories found: (condition and source)
 None.

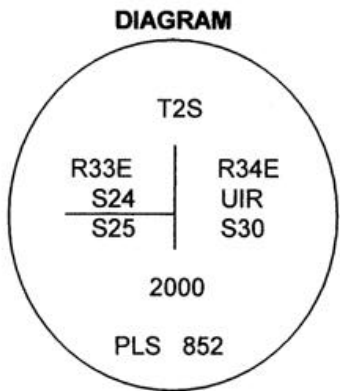

- ⊙ = Brass cap
- = Reference
- = Guard Post

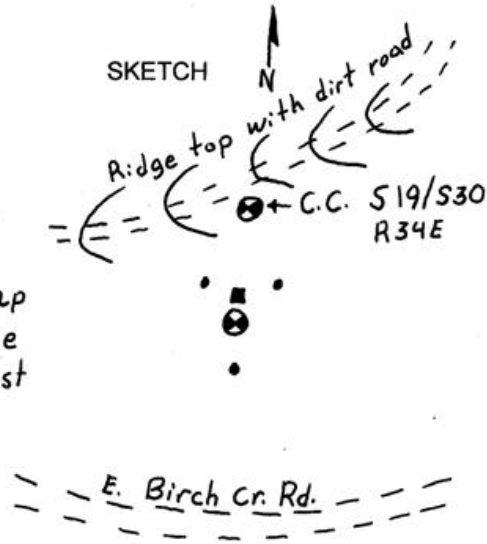

MONUMENT (S) AND ACCESSORIES SET (Procedures and Description)

Set a 1 1/4" x 30" Galvanized Iron Pipe with a 2 1/2" brass cap stamped as shown in the diagram above at the proportional point. Set a 6' steel post with a county monument sign attached along side.

For references, I set three 5/8" by 24" rebars with 1.25" red plastic caps stamped ORLS 852 and WAL5 13922 as described below and a brass cap as described above at the position of the closing corner to sections 19 and 30, range 34 east.

- an iron rebar bears N26°00'38"W, 113.15 feet;
- an iron rebar bears N34°42'46"E, 100.50 feet;
- an iron rebar bears S05°23'43"E, 21.23 feet;
- the closing corner bears N00°39'33"W, 246.33 feet;

The monument and references were tied using a LIECA system 300 RTK GPS.

Location and comments

Compass Declination

Surveyors Seal

RECEIVED BY:
 Umatilla County Surveyor
 Date: 7-00
 Rec'd By: KK
 No. 00-152-C

Firm / Agency
 Haddock Surveying
 Address
 P.O. Box 1574
 Pendleton, Or. 97801
 Party Chief
 Stephen K, Haddock

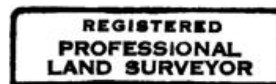

David L. Haddock

