

OREGON CORNER RESTORATION FORM

Section 22 Township 2S Range 33E
 County Umatilla Date: April 27, 2000

Corner Designation: 2S33N13

Corner to sections 15, 16, 21, and 22, T2S, R33E,
 W.M., Umatilla County, Oregon.

Condition Report Only
 Not found
 Remonumented
 Unrecorded
 Surveyed in
 Referenced out

Previous Renewals / Surveys, etc.

Corner originally set by John C. Arnold under contract #551 dated March 19, 1890.

His record reads: Set basalt stone, 14 x 8 x 6 ins., 10 ins. in ground for cor. to secs. 15, 16, 21 & 22, marked 3 notches on S. and 3 notches on E. and raised mound of stone 2 ft. high x 4 1/2 foot base over cor., from which:

A pine, 24 ins. diam. brs. N12°30'E, 157 lks. dist., marked T2S, R33E, S25BT;

Monument and Accessories found: (condition and source)

The original stone, plainly chisled, firmly in place. The mound consisted of 4 other stones. A 34" dbh live ponderosa pine plainly scribed with a State of Oregon location poster attached..

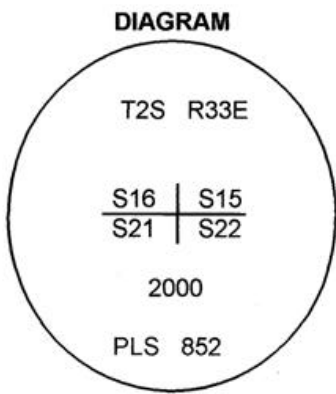

- = Brass Cap
- = Guard Post
- = Reference

SKETCH

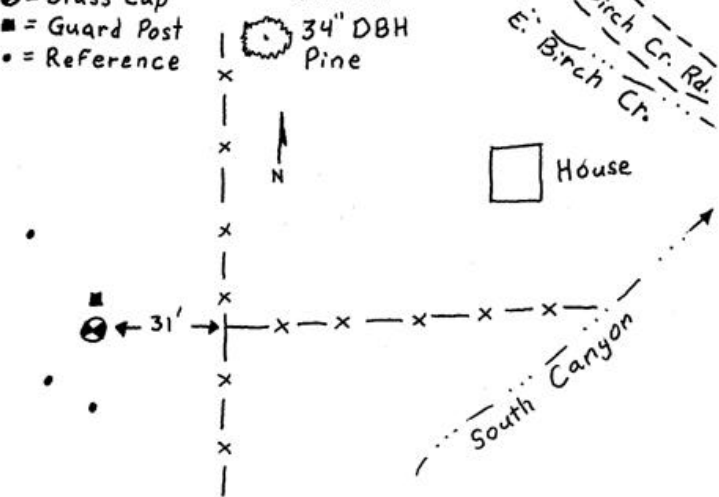

MONUMENT (S) AND ACCESSORIES SET (Procedures and Description)

Set a 1 1/2" x 30" galvanized iron pipe with a 2 1/4" brass cap stamped as shown in the diagram above at the position of the original stone. Buried the stone along side. Set a 6' steel post with a county monument sign attached along side.

For references, I set three, 5/8" by 24" rebars with 1.25" red plastic caps stamped ORLS 852 and WAL5 13922 as described below:

- an iron rebar bears N41°58'57"W, 33.49 feet;
- an iron rebar bears S53°21'18"W, 32.19 feet;
- an iron rebar bears S00°45'36"W, 61.72 feet;

The monument and references were tied using a LIECA system 300 RTK GPS.

Location and comments

Compass Declination

Surveyors Seal

RECEIVED BY:
Umatilla County Surveyor
 Date: 7-00
 Rec'd By: KK
 No. 00-156-C

Firm / Agency
 Haddock Surveying
 Address
 P.O. Box 1574
 Pendleton, Or. 97801
 Party Chief
 Stephen K, Haddock

REGISTERED
 PROFESSIONAL
 LAND SURVEYOR

David L. Haddock

OREGON
 JULY 12, 1969
 DAVID L. HADDOCK
 852