

OREGON CORNER RESTORATION FORM

Section 12 Township 2S Range 31E
 County Umatilla Date: March 4th, 2022

Corner Designation: 2S31J23

Condition report only
 Not Found

Quarter Corner common to Sections 12, and 13, T2S,
 R31E, W.M., Umatilla County, Oregon.

X Remonumented
 Unrecorded
 Surveyed In
X Referenced Out

Previous Renewals, Surveys, etc...

This corner was originally set by Daniel Chaplin under GLO contract 107 dated September 21st, 1864.
 His record reads: Set stone 20x12x4 for 1/4 sec. cor.

Monument and accessories found: (condition and source)

A basalt stone 20"x12"x4" marked 1/4 on the N. face set in a 3 feet diameter mound of stone.

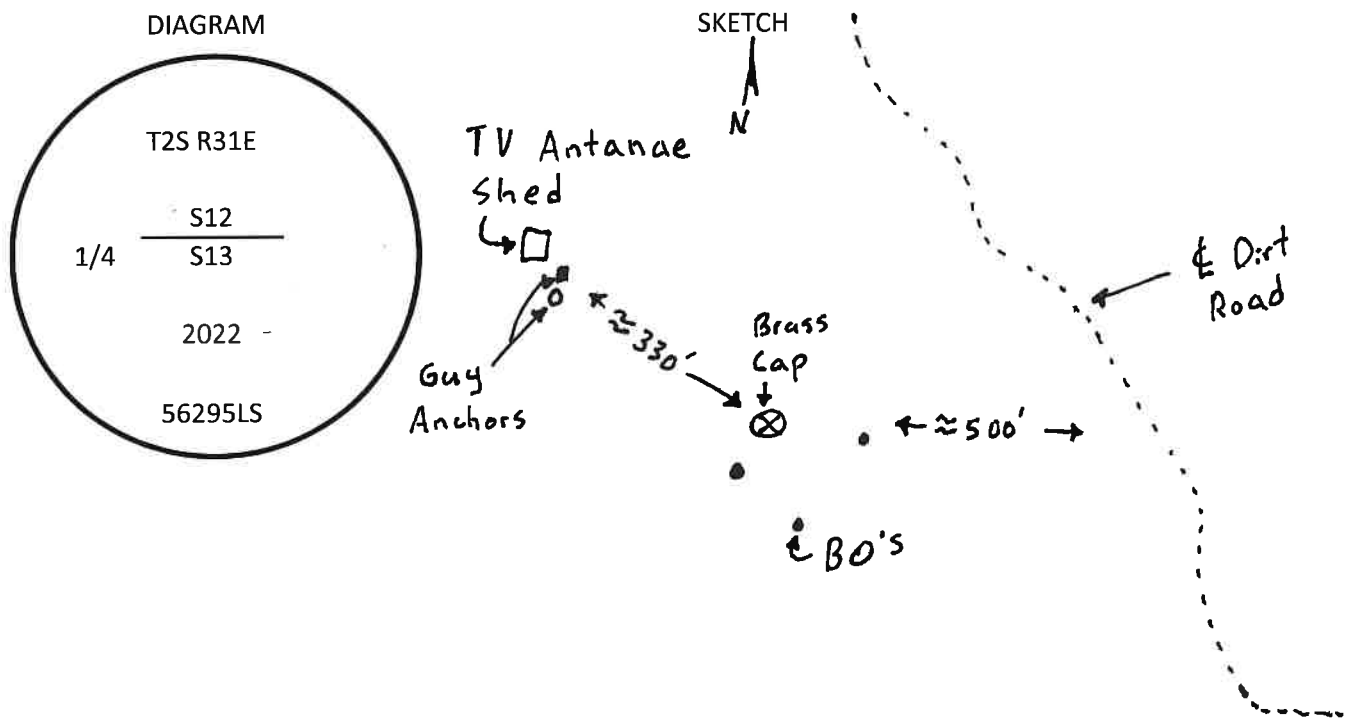

MONUMENT(S) AND ACCESSORIES SET (Procedures and Description)

At the position of the found original stone I set a 2 3/8" brass cap on a 2 3/8"x30" galvanized iron pipe 20" in the ground to bedrock. I buried the original stone upside down on the north side of the pipe and added stones and dirt to the mound to the top of the cap.

For references I set three 5/8" by 24" iron rebars with 1.25" orange plastic caps stamped WTS and 56295LS as described below:

- An iron rebar bears S27°25'37"W 24.79 feet 22 inches in the ground with a small collar of stone;
- An iron rebar bears S65°59'23"E 108.87 feet 20 inches in the ground with a small collar of stone;
- An iron rebar bears S13°12'38"E 128.81 feet flush with the surface;
- A 1"x1/2" rectangular iron bar guy anchor bears N74°18'49"W, 309.28, feet 6 inches above the ground;
- A 1/2" iron pipe guy anchor bears N74°41'04"W 312.89 feet, 12 inches above the ground;

The monument was tied using a Trimble R8S RTK GPS Base - Rover pair.

Location and comments:

Compass Declination

Surveyor's Seal

RECEIVED BY: CT
 Umatilla County Surveyor
 Date: 4/21/22
 Rec'd By: 22-045-BC

Firm / Agency
 Witness Tree Surveying
 Address
 P.O. Box G
 Pilot Rock, OR 97868
 Party Chief
 Stephen K. Haddock

REGISTERED
 PROFESSIONAL
 LAND SURVEYOR

Stephen K. Haddock

OREGON
 JULY 9, 2001
 STEPHEN K. HADDOCK
 56295LS

RENEWS: 6-30-23