

CERTIFIED RECORD OF LAND CORNER MONUMENTATION

J - 17

History of original corner establishment:

The original corner was established by Daniel Chaplin on November 19, 1864, under GLO contract No. 107, as follows:

Set a stone, 18" x 15" x 5", for the corner to sections 10, 11, 14 & 15.

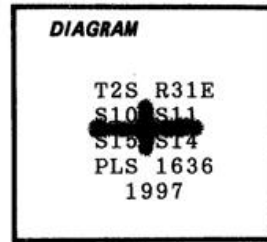

Description of corner evidence found:

Found the corner stone plainly marked with 2 notches on one edge and 2 notches on another. The stone is lying flat on the ground and is nearly flush with the surface of the ground. There are no other stones in the vicinity. The stone is 18" x 14" x 4".

Description of monument and accessories I established to perpetuate the original location of this corner:

In place of the stone, I set a 1 1/2" x 30" iron pipe 28" into the ground. A 2 1/2" brass cap attached is marked as shown in the diagram above. I bury the corner stone along the north side of the pipe monument and build a mound of stones around the pipe and the cap, from which:

A 5/8" x 36" iron rod, set 35" into the ground with a 3/4" brass washer, marked "PLS 1636 S11", attached at ground level, bears N60° E, 122.8 feet.

A 5/8" x 36" iron rod, set 35" into the ground with a 3/4" brass washer, marked "PLS 1636 S14", attached at ground level, bears S22° E, 120.4 feet.

A 5/8" x 36" iron rod, set 35" into the ground with a 3/4" brass washer, marked "PLS 1636 S15", attached at ground level, bears S54° W, 160.6 feet.

A 5/8" x 36" iron rod, set 35" into the ground with a 3/4" brass washer, marked "PLS 1636 S10", attached at ground level, bears N45° W, 142.7 feet.

This corner is about 50 feet southeast of a farm road traversing the top of a ridge.

I hereby certify the above corner point was perpetuated as hereon described on April 28, 1997. Magnetic declination: 20° E.
Witness: Milena Gaylord

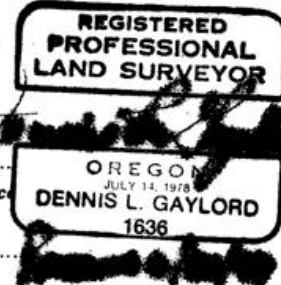

Office of _____ County of _____
 State of _____, I hereby certify that the within instrument was filed in this office for record on the 29 day of April, 1997.
 _____ by _____
 (COUNTY OFFICIAL) (DEPUTY)

Form R6-7100-57 (9/71)

RECEIVED BY
 Umatilla County Surveyor
 Date 4-97
 Rec'd By KK
 No. 97-85-R

GPO-791-311