

**OREGON CORNER RESTORATION FORM**

Section 1 Township 2S Range 31E  
 County Umatilla Date: April 8, 2011

Corner Designation: 2S31E21

Corner to sections 1, 2, 11, and 12, T2S, R31E,  
 W.M., Umatilla County, Oregon.

Condition Report Only  
 Not found  
 Remonumented  
 Unrecorded  
 Surveyed in  
 Referenced out

Previous Renewals / Surveys, etc.

Corner originally set by Daniel Chaplin under contract No. 107 dated September 21, 1864. His record reads: Set stone 30x24x24 for Cor. to Secs. 1, 2, 11 & 12.

Monument and Accessories found: ( condition and source )

I found what appears to be the original basalt stone on the easterly edge of a turn out in the County Road. There were no visible marks. The corner point falls in the asphalt of Yellow Jacket Road. I held the intersection of fences running north and east as the best available evidence of the corner point.

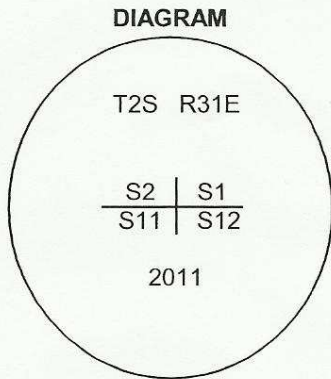

□ = Set Railroad Spike  
 ● = Iron Rebar Reference

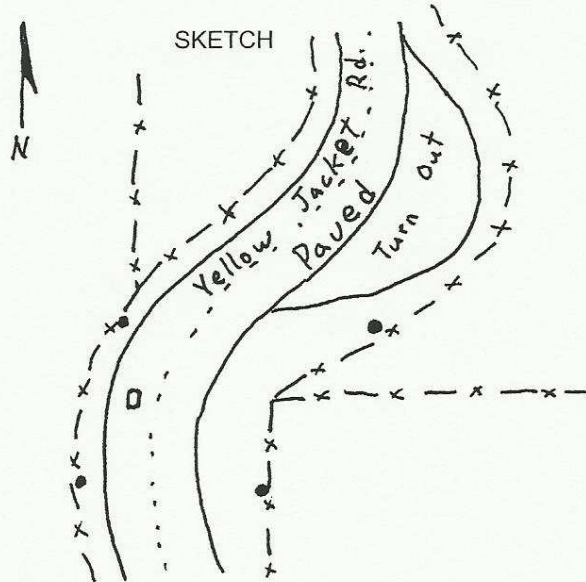

**MONUMENT (S) AND ACCESSORIES SET (Procedures and Description)**

At the true corner point I set a railroad spike flush with the surface of the asphalt stamped as shown in the diagram above.

For references, I set four, 5/8" by 24" rebars with 1 1/8" orange plastic caps attached, stamped WTS and 56295LS as described below:

- an iron rebar bears N40°26'50"W, 26.15 feet under the west right of way fence;
- an iron rebar bears S61°18'2"W, 26.44 feet under the west right of way fence;
- an iron rebar bears N73°33'28"E, 76.98 feet under the east right of way fence;
- an iron rebar bears S69°59'48"E, 57.48 feet under the east right of way fence;

The monument and references were tied using a Trimble R7/R8 RTK GPS.

Location and comments

Compass Declination

Surveyors Seal

RECEIVED BY:  
Umatilla County Surveyor  
 Date: \_\_\_\_\_  
 Rec'd By: \_\_\_\_\_  
 No. 11-112-C

Firm / Agency  
 Witness Tree Surveying  
 Address  
 P.O. Box G  
 Pilot Rock, Or. 97868  
 Party Chief  
 Stephen K, Haddock

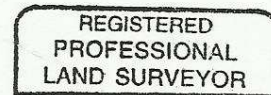

*Stephen K. Haddock*

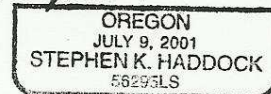

RENEWAL DATE 6-30-13