

OREGON CORNER RESTORATION FORM

Section 3 Township 2S Range 31E
 County Umatilla Date: June 16, 2011

Corner Designation: 2S31E15

Condition Report Only

- Not found
- Remonumented
- Unrecorded
- Surveyed in
- Referenced out

Quarter corner to sections 3 and 10, T2S, R31E,
 W.M., Umatilla County, Oregon.

Previous Renewals / Surveys, etc.

Corner originally set by Daniel Chaplin under contract No. 107 dated September 21, 1864. His record reads: Set stone, 14x10x6, for 1/4 Sec. Cor.

Monument and Accessories found: (condition and source)
 None. The point falls in a plowed field.

DIAGRAM

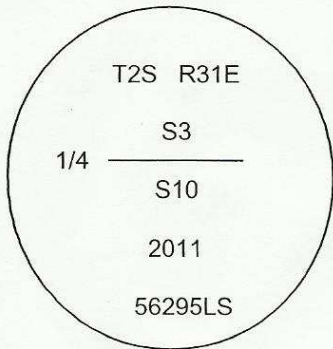

SKETCH

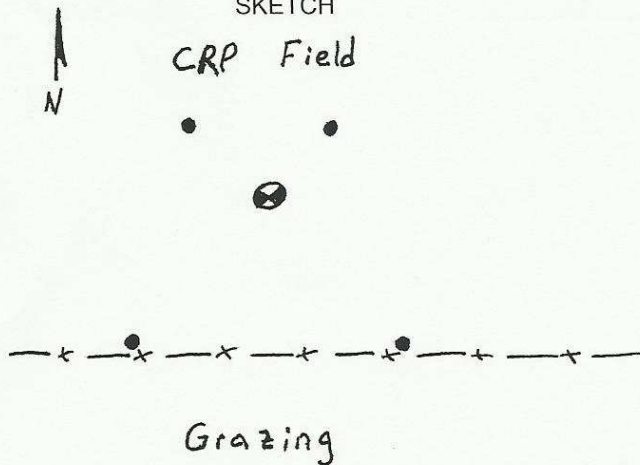

- = Set Brass Cap
- = Rebar Reference

MONUMENT (S) AND ACCESSORIES SET (Procedures and Description)

At the proportioned point I set a 1 1/2" x 30" galvanized iron pipe with a 2 3/8" brass cap stamped as shown in the diagram above 20 inches below the surface of the field.

For references, I set four 5/8" by 24" rebars with 1 1/8" orange plastic caps stamped WTS and 56295LS as described below:

- an iron rebar bears N39°55'36"W, 22.94 feet, 20 inches below the surface of the field;
- an iron rebar bears N34°01'28"E, 22.16 feet, 20 inches below the surface of the field;
- an iron rebar bears S25°54'39"E, 68.39 feet, under the existing fence;
- an iron rebar bears S38°07'12"W, 76.92 feet, under the existing fence;

The monument was set and references tied using a Trimble R7/R8 RTK GPS system.

Location and comments

Compass Declination

Surveyors Seal

RECEIVED BY:
 Umatilla County Surveyor
 Date: _____
 Rec'd By: _____
 No. 11-112-C

Firm / Agency
 Witness Tree Surveying
 Address
 P.O. Box G
 Pilot Rock, Or. 97868
 Party Chief
 Stephen K, Haddock

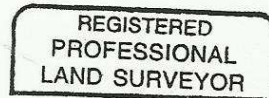

Stephen K. Haddock

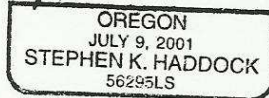

RENEWAL DATE 6-30-13