

OREGON CORNER RESTORATION FORM

COUNTY: Umatilla DATE: 01/25/06

CORNER DESIGNATION: 2N31, N-19, The South One-Quarter Corner of Section 14.

PREVIOUS RENEWALS/SURVEYS ETC.: Corner established by Josiah A. Burnett, under Contract No. 92, dated September 12, 1860. Record states: Set a post for 1/4 Sec. corner, drove charred stake and raised mound with trench, as per instructions.

The corner was recovered by John Kimbrell in survey recorded in Book 1, Page 571. The record does not state what was recovered for the original corner.

MONUMENT AND ACCESSORIES FOUND:
Found and held a 1/2 x 24" iron rebar at a ancient fence corner with fences South and West. The origin of this rebar is not known.

MONUMENT MARKING DETAIL:

T2N R31E
1 S14
4 S23
2006
PLS 1106

MONUMENT SET:

At the position of the found 1/2" rebar, set a 5/8" x 24" rebar with 2" aluminum cap, 20" in the ground to bedrock and raised a mound of stone and earth top of cap. Monument marked as shown in Monument Marking Detail.

A 5/8" x 24" iron rebar with yellow plastic cap stamped "OR PLS 1106, WA PLS 17372", bears North 69° East, 31.6 feet.

A 5/8" x 24" iron rebar with yellow plastic cap stamped "OR PLS 1106, WA PLS 17372", bears South 0 1/2° East, 28.3 feet.

A 5/8" x 24" iron rebar in fence line with yellow plastic cap stamped "OR PLS 1106, WA PLS 17372", bears West, 22.8 feet.

A 5/8" x 24" iron rebar with yellow plastic cap stamped "OR PLS 1106, WA PLS 17372", bears North 32° West, 35.2 feet.

Attached bearing object signs to all rebar accessories. Attached a witness sign to the fence corner by the monument.

LOCATION AND COMMENTS:

Corner is located on a Northwest slope West of the top of a rocky ridge.

OREGON STATE PLANE COORDINATE, North Zone, NAD 83(91), International Feet:

N = 725629.60
E = 8610810.99

FIRM: William R. Wells, PLS
P.O. Box 1696
Pendleton, OR 97801

COMPASS DECLINATION: 18° East

Surveyor's Seal

Witnesses: Jason Wells, LSIT

/2N31N19

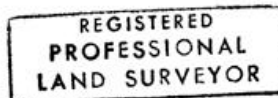

William R. Wells

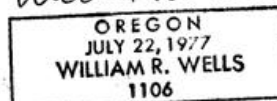

renews 6-30-08

06-462-C