

OREGON CORNER RESTORATION FORM

COUNTY: Umatilla DATE: 02/21/06

CORNER DESIGNATION: 2N31, J-9, The Northeast Corner of Section 17.

PREVIOUS RENEWALS/SURVEYS ETC.: Corner originally established by Josiah A. Burnett, under Contract No. 92, dated September 12, 1860. Record states: Set a post for corner to Secs. 8, 9, 16 & 17. Drove charred stake and raised mound with trench, as per instructions.

John Kimbrell indicates he recovered the corner on survey recorded at Book 1, Page 348. Record states: "Set Stone in Md. of Stone". Kimbrell record indicates corner is West of head of draw by about 50 feet.

A mound of stone was found on Survey No. 03-293-B, PLS933, in 1971.

MONUMENT AND ACCESSORIES FOUND:

Found mound of stone with an old wood hub in it as reported on Record of Survey No. 03-293-B, dated 1971.

MONUMENT MARKING DETAIL:

T2N R31E
S8|S9
S17|S16
2006
PLS 1106

MONUMENT SET:

Held position of the found hub and set a 5/8" x 24" rebar with 2" aluminum cap 22" in the ground and raised a mound of stone to the top of the cap. Monument marked as shown in monument marking detail.

A 5/8" x 24" iron rebar with yellow plastic cap stamped "OR PLS 1106, WA PLS 17372", bears North 89° East, 28.4 feet.

A 5/8" x 24" iron rebar with yellow plastic cap stamped "OR PLS 1106, WA PLS 17372", bears South 37° East, 36.9 feet.

A 5/8" x 24" iron rebar with yellow plastic cap stamped "OR PLS 1106, WA PLS 17372", bears South 28 1/2° West, 17.4 feet.

A 5/8" x 24" iron rebar with yellow plastic cap stamped "OR PLS 1106, WA PLS 17372", bears North 05° West, 19.5 feet.

Attached bearing object signs to all rebar accessories. Nailed witness sign to wood fence post in North-South fence 8 feet West of monument.

LOCATION AND COMMENTS:

Corner is located 20' west of the head of a steep rocky draw bearing Southwest approximately 8' West of an existing North-South fence. The draw is also about 50 feet South of corner point.

OREGON STATE PLANE COORDINATE, North Zone, NAD 83(91), International Feet:

N = 730684.24
E = 8597533.52

FIRM: William R. Wells, PLS
P.O. Box 1696
Pendleton, OR 97801

COMPASS DECLINATION: 18° East

Surveyor's Seal

Witnesses: Jason Wells, LSIT

/2N31J9

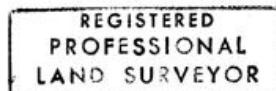

William R. Wells

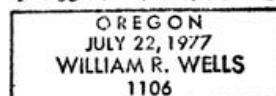

renews 6-30-08

06-462-c