

OREGON CORNER RESTORATION FORM

COUNTY: Umatilla DATE: 06/29/06

CORNER DESIGNATION: 2N31, J-21, The Southwest Corner of Section 12.

PREVIOUS RENEWALS/SURVEYS ETC.: Corner was originally established by Josiah A. Burnett, under Contract No. 92, dated September 12, 1860. Record states: Set post for corner to Sec.s 11, 12, 13 and 14, from which:

A cottonwood, 8 in dia. Bears N 30° E., 15 lks. dist.

A cottonwood, 4 in dia. Bears N 10° W., 12 lks. dist.

John Kimbrell, on Survey recorded at Book 1, Page 359, in 1897), calls the corner point in the river and states he "set a post on North bank if the river as a witness".

MONUMENT AND ACCESSORIES FOUND: None. Corner falls North of Umatilla River in vegetated riparian area that has flooded many times.

MONUMENT MARKING DETAIL:

T2N R31E
S11|S12
S14|S13
2006
PLS 1106

MONUMENT SET:

I reestablished this corner using the Burnett record rather than the Kimbrell record. At the reestablished corner point, set a 2 3/8" brass cap on 1 1/4" x 30" galvanized iron pipe, 27" in the ground and surrounded with mound of earth. Monument marked as shown in Monument Marking Detail.

From which:

A 5/8" x 24" iron rebar with 1 1/4" red plastic cap marked "OR PLS 1106 WA PLS 17372" bears North 86° East, 29.7 feet.

A 5/8" x 24" iron rebar with 1 1/4" red plastic cap marked "OR PLS 1106 WA PLS 17372" bears South 32 1/2° East, 37.2 feet. (This rebar is North 32 1/2° West, 8 inches from a 30" dia. silver maple tree.)

A 5/8" x 24" iron rebar with 1 1/4" red plastic cap marked "OR PLS 1106 WA PLS 17372" bears South 90° West, 45.7 feet.

A 5/8" x 24" iron rebar with 1 1/4" red plastic cap marked "OR PLS 1106 WA PLS 17372" bears North 07 1/2° West, 31.5 feet.

Attached bearing object signs to all rebar accessories. Set steel fence post with witness sign attached 1' South of monument.

LOCATION AND COMMENTS: Corner is located in a riparian area along the North bank of the Umatilla river 100'+- North of the river and 100'+- South of the Union Pacific Railroad tracks.

OREGON STATE PLANE COORDINATE, North Zone, NAD 83(91), International Feet:

N = 730933.26
E = 8613265.77

FIRM: William R. Wells, PLS
P.O. Box 1696
Pendleton, OR 97801

COMPASS DECLINATION: 18° East

Surveyor's Seal

Witnesses: Jason Wells, LSIT

/2N31J21

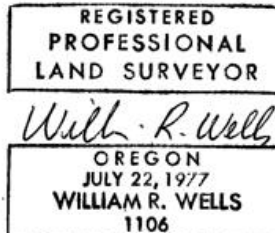

renews 6-30-08

176-1167 c