

**OREGON CORNER RESTORATION FORM**

COUNTY: Umatilla DATE: 01/23/06

CORNER DESIGNATION: 2N31, J-17, The Northeast Corner of Section 15

PREVIOUS RENEWALS/SURVEYS ETC.: Corner established by Josiah A. Burnett, under Contract No. 92, dated September 12, 1860. Record states: Set a post for corner to Secs. 10, 11, 14 and 15. Drove charred stake and raised mound with trench, as per instructions. Corner was reestablished by John Kimbrell in survey recorded at Book 1, Page 348. Record states: "Set Stone 22 x 6 x 6 for Cor to Secs 10-11-14-15".

**MONUMENT AND ACCESSORIES FOUND:**

Found 15"x5"x5" stone set firmly in ground with top 3" above ground level. A 12"x10"x7" stone and a 21"x9"x5" stone were also found buried on their sides flanking the set stone. The North post of an old stock gate is 6 feet Southerly from the set stone. There is an existing fence extending North, and remains of fence (rock jack mounds and wire) extending East from the set stone.

**MONUMENT MARKING DETAIL:**

T2N R31E  
S10|S11  
S15|S14  
2006  
PLS 1106

**MONUMENT SET:**

At the position of the set stone, set a 1 1/4" x 30" galvanized iron pipe with 2 3/8" brass cap, 26" in the ground. Raised mound of earth and stone to the top of the cap. Stamped cap as shown in Monument Marking Detail.

From which:

A 5/8" x 24" iron rebar with yellow plastic cap stamped "OR PLS 1106, WA PLS 17372", bears North 33° East, 38.6 feet.

A 5/8" x 24" iron rebar with yellow plastic cap stamped "OR PLS 1106, WA PLS 17372", bears South 35° East, 47.1 feet.

A 3/4" brass washer stamped "PLS 1106" 1 foot above ground level in the South post of a old stock gate bears South 01° West, 21.3 feet.

A 5/8" x 24" iron rebar with yellow plastic cap stamped "OR PLS 1106, WA PLS 17372", bears North 31° West, 41.1 feet.

Attached bearing object signs to all rebar accessories. Nailed bearing object sign to gate post with the brass washer. Attached witness sign to North gate post 6 feet Southerly of monument.

**LOCATION AND COMMENTS:**

Corner is located in a steep unfarmed area sloping East, surrounded by a farmed field, approximately 100' West of the bottom of a gulch.

OREGON STATE PLANE COORDINATE, North Zone, NAD 83(91), International Feet:

N = 730878.43  
E = 8608017.06

FIRM: William R. Wells, PLS  
P.O. Box 1696  
Pendleton, OR 97801

COMPASS DECLINATION: 18° East

Witnesses: Jason Wells, LSIT

/2N31J17

Surveyor's Seal

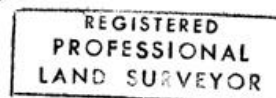

*William R. Wells*  
OREGON  
JULY 22, 1977  
WILLIAM R. WELLS  
1106

*Renews 6-30-08 116-462-C*