

**OREGON CORNER RESTORATION FORM**

COUNTY: Umatilla DATE: 03/15/06

CORNER DESIGNATION: 2N31, E-7, The South One-Quarter Corner of Section 5.

PREVIOUS RENEWALS/SURVEYS ETC.: Corner established by Josiah A. Burnett, under Contract No. 92, dated September 12, 1860. Record states: Set a post for 1/4 Sec. corner, drove charred stake and raised mound with trench, as per instructions.

MONUMENT AND ACCESSORIES FOUND: None.

MONUMENT MARKING DETAIL:

T2N R31E  
1 S5  
4 S8  
2006  
PLS 1106

MONUMENT SET:

Re-established corner by single proportionate measure the between the reestablished Northwest and Northeast corners of Section 8. At reestablished corner position, set a 2 3/8" brass cap on 1 1/4" x 30" galvanized iron pipe with cap 16" below ground level in a farmed field. Monument marked as shown in monument marking detail.

From which:

- A 5/8" x 24" iron rebar with red 1 1/4" red plastic cap marked "OR PLS 1106 WA PLS 17372" 2" above ground level in unfarmed scab area bears North 09° East, 33.2 feet.
- A 5/8" x 24" iron rebar with red 1 1/4" red plastic cap marked "OR PLS 1106 WA PLS 17372" 2" above ground level in unfarmed scab area bears North 43 1/2° East, 32.2 feet.
- A 5/8" x 24" iron rebar with red 1 1/4" red plastic cap marked "OR PLS 1106 WA PLS 17372" 2" above ground level in unfarmed scab area bears South 70° East, 28.1 feet.
- A 5/8" x 24" iron rebar with red 1 1/4" red plastic cap marked "OR PLS 1106 WA PLS 17372" 2" above ground level in unfarmed scab area bears South 23° East, 32.1 feet.

Attached bearing object signs to all rebar accessories. Set steel fence post with witness sign attached in unfarmed scab area 6 feet East of the monument.

LOCATION AND COMMENTS: Corner is located in a farmed wheat field, 6 feet West of a unfarmed scab area, and approximately 200 feet West of a small draw running North-South.

OREGON STATE PLANE COORDINATE, North Zone, NAD 83(91), International Feet:

N = 735847.91  
E = 8594753.94

FIRM: William R. Wells, PLS  
P.O. Box 1696  
Pendleton, OR 97801

COMPASS DECLINATION: 18° East

Surveyor's Seal

Witnesses: Jason Wells, LSIT

/2N31E7

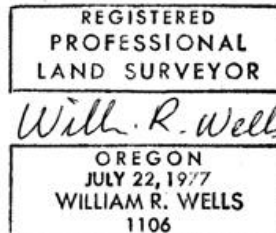

*renews 6-30-08*