

OREGON CORNER RESTORATION FORM

COUNTY: Umatilla DATE: 05/15/06

CORNER DESIGNATION: 2N31, E-13, The Southwest Corner of Section 3.

PREVIOUS RENEWALS/SURVEYS ETC.: Corner established by Josiah A. Burnett, under Contract No. 92, dated September 12, 1860. Record states: Set a post for corner to Secs. 3, 4, 9 and 10, drove charred stake and raised mound with trench, as per instructions. Burnett calls a dry ravine, 6.50 chains, (429 feet) West of corner.

There is a call to this corner point in unrecorded 1927 deed for Barnhart Road, (Sturgis to Umatilla County), but the call of 446 feet from road centerline to Section corner does not check features found on the ground for this section corner. The distance from the section corner to the road is more like 350 feet. The unrecorded deed copy was found in Umatilla County Road Department records.

Corner was called as recovered on 1903 G. Kimbrell survey recorded at Book 1, Page 484.

MONUMENT AND ACCESSORIES FOUND: None. There are remains of a North-South fence line, (wire and rock jacks), North of draw about 300 feet North of corner. There are also a few loose wood posts scattered about the corner area. Remains of a old power pole line and East-West fence line are visible on hillside West of Barnhart Road.

MONUMENT MARKING DETAIL:

T2N R31E
S4|S3
S9|S10
2006
PLS 1106

MONUMENT SET:

Re-established corner by double proportionate measure, using the Josiah Burnett record. I considered but did not use, the 6.5 chain topo call in the Burnett record. At reestablished corner position, set a 2 3/8" brass cap on 1 1/4" x 30" galvanized iron pipe with cap 1" above ground level and surrounded with mound of earth. Monument marked as shown in monument marking detail. Reestablished corner lines up well with fence remains to the North.

From which:

A 5/8" x 24" iron rebar with 1 1/4" red plastic cap marked "OR PLS 1106 WA PLS 17372" bears North 77 1/2° East, 32.0 feet.

A 5/8" x 24" iron rebar with 1 1/4" red plastic cap marked "OR PLS 1106 WA PLS 17372" bears South 08 1/2° East, 31.5 feet.

A 5/8" x 24" iron rebar with 1 1/4" red plastic cap marked "OR PLS 1106 WA PLS 17372" bears South 60° West, 39.5 feet.

A 5/8" x 24" iron rebar with 1 1/4" red plastic cap marked "OR PLS 1106 WA PLS 17372" bears North 15 1/2° West, 29.6 feet.

Attached bearing object signs to all rebar accessories. Set steel fence post with witness sign attached 1 foot East of monument.

LOCATION AND COMMENTS: Corner is located on a West slope 200'+- South of a East-West draw. Corner is visible from Barnhart Road. Corner falls in a area that was farmed in the past.

OREGON STATE PLANE COORDINATE, North Zone, NAD 83(91), International Feet:

N = 736027.20
E = 8602643.78

FIRM: William R. Wells, PLS
P.O. Box 1696
Pendleton, OR 97801

COMPASS DECLINATION: 18° East

Surveyor's Seal

Witnesses: Jason Wells, LSIT
/2N31E13

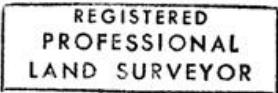

William R. Wells

