

# OREGON CORNER RESTORATION FORM

T2N R28E Z5

Section 31, Township 2N, Range 28E,  
County Umatilla, Date February 10, 2005.

Corner common to Sections 5 & 6, T1N and Sections  
31 & 32, T2N, R28E, W.M., Umatilla County, Oregon.

— Condition Report  
— Not Found  
 Remonumented  
— Unrecorded  
— Surveyed in  
 Referenced out

Previous Renewals / Surveys, etc.

The corner was originally set by David P. Thompson under Contract No. 83 dated July 22, 1859. His record Reads: Set post for corner to Secs. 5, 6, 31, and 32, in mound of earth and c. as per instructions.

Monument and accessories found: (Condition and source)

A point with 3 decayed posts and some charcoal approximately 9 feet west of the current fence corner location. This point was identified as the corner by Mr. George Luciani who has owned this land since 1964.

DIAGRAM

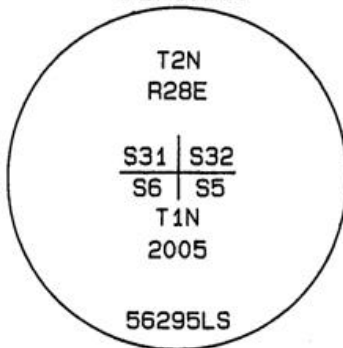

- ⊗ = Brass Cap
- = Iron Rebar Reference

SKETCH

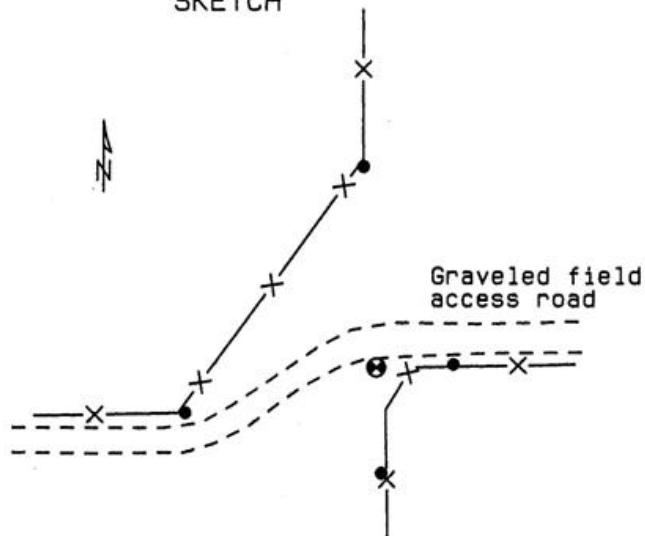

Monument and accessories set: (Procedures and description)

I set a 2 3/8" brass cap on a 30" x 2 3/8" O.D. galvanized iron pipe 12" below the surface of the ground. The cap was stamped as shown in the diagram above.

For references I set four 5/8" x 24" iron rebars with 1.25" orange plastic caps stamped WTS and 56295LS:

- an iron rebar bears N03°58'10"W 99.08 feet;
- an iron rebar bears N87°30'28"E 38.35 feet;
- an iron rebar bears S02°58'04"E 52.53 feet;
- an iron rebar bears S76°30'50"W 97.61 feet;

The monument and references were set and tied using a Trimble R7/R8 GPS system and static surveying methods. Bearings and distances are Grid.

Location and Comments  
SPC Oregon North, NAD 83-91  
Northing = 707,953.95 ft  
Easting = 8,495,897.76 ft

Compass Declination

Surveyor's Seal

Witnessed By:  
RECEIVED BY:  
Umatilla County Surveyor  
Date: 5-05  
Rec'd By: KK  
No. 05-111-C

Firm / Agency  
Witness Tree Surveying  
P.O. Box G  
Pilot Rock, OR 97868  
Party Chief  
Stephen K. Haddock, PLS

REGISTERED  
PROFESSIONAL  
LAND SURVEYOR

*Stephen K. Haddock*  
OREGON  
JULY 9, 2001  
STEPHEN K. HADDOCK  
56295LS

RENEWAL DATE 6-30-05