

OREGON CORNER RESTORATION FORM

T2N R27E V1

Section 31, Township 2N, Range 27E,
 County Morrow, Date February 1, 2005.

- Condition Report
- Not Found
- Remonumented
- Unrecorded
- Surveyed in
- Referenced out

Corner common to Sections 25 & 36 R26E and Sections 30 & 31, R27E, T2N, W.M., Morrow County, Oregon.

Previous Renewals / Surveys, etc.

The corner was originally set by Ebenezer Haft under Contract No. 93 dated September 11, 1860. His record Reads: Set post for corner to Secs 30, 31, 25 & 36 in mound with trench and pits and deposited 1 pint of charcoal as per instructions. The O.S.H.D. stockpile site survey 1R-5-223 shows the section line as along the centerline of the highway. This map and their deed give a "more or less" distance tie to the corner.

Monument and accessories found: (Condition and source)
 None. The position falls in the centerline of the County Road.

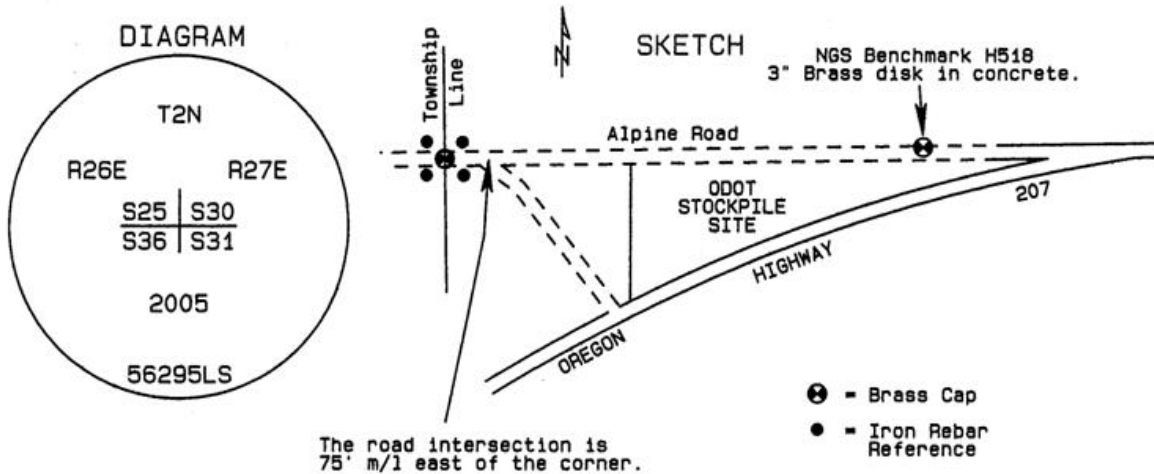

Monument and accessories set: (Procedures and description)

At the intersection of the Township line with the centerline of County Road 927 I set a 2 3/8" x 30" galvanized iron pipe with a 2 3/8" brass cap stamped as shown above approximately 10" below the surface of the road.

For references I set four 5/8" x 24" iron rebars with 1.25" orange plastic caps attached stamped WTS and 56295LS 24" below the surface of the field:
 an iron rebar bears N46°27'44"E 24.03 feet;
 an iron rebar bears N46°41'21"W 24.68 feet;
 an iron rebar bears S48°14'55"W 24.26 feet;
 an iron rebar bears S49°14'13"E 24.95 feet;
 USGS Bench Mark H518, a 3" brass disk in concrete, bears N88°36'53"E 950.95 feet;

The monument and references were tied with a Trimble R7/R8 GPS system using static surveying procedures. Bearings and distances are grid.

Location and Comments
 SPC Oregon North, NAD 83-91
 Northing = 712,847.22 ift
 Easting = 8,458,428.82 ift

Compass Declination

Surveyor's Seal

Witnessed By:
 RECEIVED BY:
Umatilla County Surveyor
 Date: 5-05
 Rec'd By: KK
 No. 05-111-C

Firm / Agency
 Witness Tree Surveying
 P.O. Box G
 Pilot Rock, OR 97868
 Party Chief
 Stephen K. Haddock, PLS

REGISTERED
 PROFESSIONAL
 LAND SURVEYOR

Stephen K. Haddock
 OREGON
 JULY 9, 2001
 STEPHEN K. HADDOCK
 56295LS

RENEWAL DATE 6-30-05