

CERTIFIED RECORD OF LAND CORNER MONUMENTATION

History of original corner establishment:

Corner originally established by Henry Meldrum under GLO contract number 450, dated June 11, 1882. Surveyor General record states:
 Set basalt stone 18x8x7 ins 12 in in ground for cor to secs 30 + 31 marked with 5 notches on N + 1 on S edges, from which;
 A pine 12 in diam bears S33°E 76 lks dist marked R37E S31 BT
 A pine 36 in diam bears N83°E 39 lks dist marked T1S S30 BT
 A fir 18 in diam bears N68°W 76 lks dist marked R36E BT

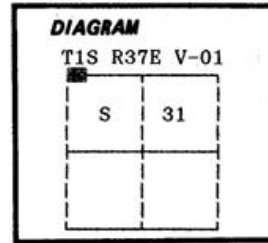

No record of subsequent monumentation found in Umatilla County survey records.

Description of corner evidence found:

Found a stone 16x8x6 inches marked with 5 grooves on one face, set in a small mound of stone.

ORIGINAL BEARING TREES

Found a 38 inch diameter Ponderosa Pine N83°E, 39 lks, live and vigorous with blaze evident.

Found a 12 inch diameter Ponderosa Pine S33°E, 76 lks, live but leaning heavily with scribes visible.

Found the rotted remains of a Fir stump N68°W, 76 lks, with scribes visible on loose slabs of wood.

Distances to the original BTs are to the estimated face of blaze.

Description of monument and accessories established to perpetuate the

original location of this corner: In place of the found original corner stone, I set a 2½" x 30" aluminum pipe with aluminum cap marked as shown, 23 inches in the ground, from which:

New Bearing Tree:

A 10 inch diameter Ponderosa Pine bears S61°E, 85.35 feet marked T1S R37E S31 CC BT

Painted a 6 inch red band around all BTs and attached bearing tree and land survey monument signs.

Set a steel fencepost approximately 5 feet North with land survey monument sign attached.

Buried the original corner stone West and alongside of monument.

Raised a mound of stone around monument, 3 ft. base to top of cap.

I hereby certify that the above corner point was perpetuated as hereon described on August 4, 1989.

Witnesses: Jeff Petersen and Rick Robinson

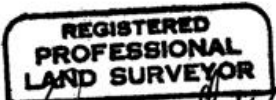
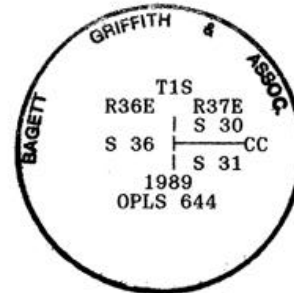

[Handwritten Signature]

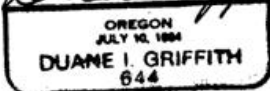

I used a steel tape and magnetic compass in the establishment of new accessories. I used 17° East magnetic declination and the distances are to a 50d spike driven in the right side of the root crown. I attached a brass washer marked OPLS 644 to the BT blaze.

Office of the Survey Dept County of Umatilla
 State of OR, I hereby certify that the within instrument was filed in this office for record on the 27th day of October, 1989
David H. Robinson by Kathleen Ambrey
 (COUNTY OFFICIAL) (DEPUTY)

Form R6-7100-57 (9/71)

RECEIVED BY
 Umatilla County Surveyor
 Date 10-29
 Book KA
 No. 89-106-L