

Form 874-9—Revised May, 1918  
U. S. Department of Agriculture  
FOREST SERVICE

Umaville NATIONAL FOREST

CORNERS OF THE PUBLIC SURVEY

T. 15 R. 36 E W. Mer.

1/4 Corner common to Sections  
28 and 33

Corner consists of a Rock (not) in place  
State condition good

Dimensions above ground 3 x 7 x 2 inches.

Sketch grooves, letters, figures, or notches, on proper face or edge.

CARDINAL POSITION

DIAGONAL POSITION

--	--	--	--

N W S E

--	--	--	--

NW SW SE NE

Mound of \_\_\_\_\_ is located \_\_\_\_\_

Pits are located \_\_\_\_\_

Sketch markings of Bearing Trees (or Rocks) in proper box and fill blanks below, giving bearings from Corner to Trees and Distances in Links.

<u>1/4 S</u>			
<u>RT</u>			

Species Y.P.

Diameter 17"

Bearing N 13 W

Distance 24'

Do you believe this to be a genuine Land Office Corner? Yes

If not, why? \_\_\_\_\_

Umaville, Oregon  
(Signature)

11-5-33 (Date) Paterson Dist. (Title)

T. 15 R. 36E W Mer.

(Make sketch of topography near Corner)

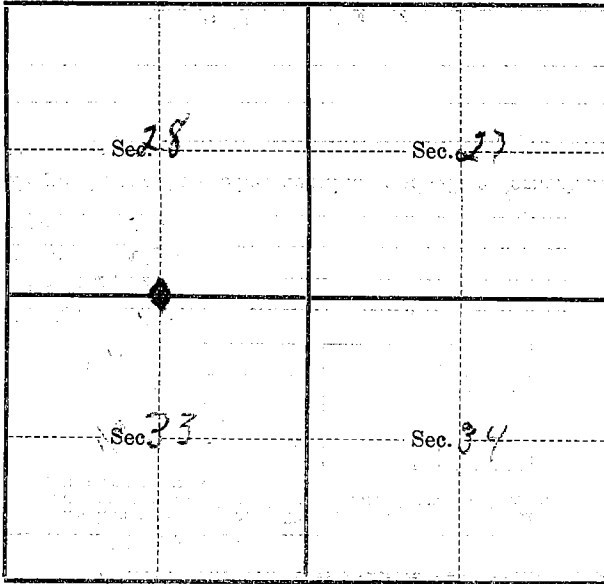

Metal Location Poster is on a 10 Bur Oak  
tree 17 inches diameter, on the S  
side of tree  
from which this Corner bears S 63 E  
24 ft chains distant.

Give any further facts which will aid in finding this  
Corner again.

USDA-FOREST SERVICE

Index File No. V-11

CORNER RECORD (SEARCH)

(Ref. FSM 7151.4)

Tract or Survey No. \_\_\_\_\_ Cor. No. \_\_\_\_\_

T 15 R. 36E R.D. \_\_\_\_\_ County UNION

Merid. WILLAMETTE N.F. UMATILLA State OREGON

CORNER DIAGRAM

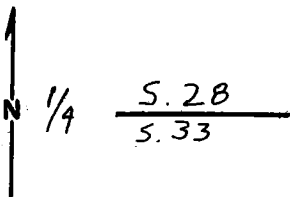

DESCRIBE CORNER MONUMENT FOUND

FOUND A 12" X 10" X 5" STONE LAYING ON SIDE WITH SCRIBES '1'

DESCRIBE BEARING TREES OR OTHER OFFICIAL ACCESSORIES FOUND

① A 20" D.B.H. PINE, N 65°W, 30 LINKS, WITH A FACE I DID NOT OPEN

PHOTO IDENTIFICATION DATA

Photo No. \_\_\_\_\_  
Filed At. \_\_\_\_\_  
Object Ident. \_\_\_\_\_  
Ident. By \_\_\_\_\_  
*Signature*

DESCRIBE CORNER LOCATION RELATIVE TO NEAR-BY FEATURES, ALSO HOW TO REACH CORNER

AT MT. EMILY TURN OFF, GO NORTH ON F.R. 31, 3.3 MILES, TURN LT. ON 023 ROAD, GO 0.17 MILES TO 4" X 4" POST ON LT. SEE LOCATION TAG, COR. 15 90' WEST.

PLANE COORDINATE POSITION DATA

State \_\_\_\_\_ Zone \_\_\_\_\_  
X \_\_\_\_\_  
Y \_\_\_\_\_  
Estab. By \_\_\_\_\_  
*Agency*

Signature \_\_\_\_\_ Title \_\_\_\_\_ Division \_\_\_\_\_ Headquarters \_\_\_\_\_ Date SEPT. 14, 1982 7100-52-(3/68)

LAND SURVEYOR

CORNER RECORD (PERPETUATION)

MONUMENT: DESCRIBE NEW MONUMENT SET, OR WORK DONE TO PRESERVE EXISTING MONUMENT

SET A 2 1/4" DIAM. BRASS CAP IN A 2" X 30" IRON PIPE AT CORNER AND STAMPED PER SKETCH.

TIS R36E  
3.28  
1/4 533  
RPLS 1910  
1982

9

ACCESSORIES : DESCRIBE NEW BT'S WITNESS OBJECTS ETC. ESTABLISHED, OR WORK DONE TO PRESERVE EXISTING EVIDENCE

① A 12" D.B.H. WHITE FIR, S. 42° E., 17', SCRIBED 1/4 533 BT, A BRASS WASHER STAMPED RPLS 1910 IS NAILED BETWEEN BIT

10

Work Done By C. J. MARTIN Title LAND SURVEYOR Date 9-14-82 State Registration No. \_\_\_\_\_ or Agency \_\_\_\_\_

Certified Cor. Record Prepared?  Yes No Filed At: UMATILLA COUNTY SURV. OFF. Date 9-82

11

REMARKS

12

Index File No. T. 15 R. 36E M. WILLAMETTE Tract or Surv. No.

Cor. 28  
U.S. G.P.O. 1977-725-576/586 13

Index

File No. V-11T 1 S. R. 36 E.Merid. Willamette

## CORNER RECORD (SEARCH)

(Ref. FSM 7151.4)

R.D. Pendleton County UmatillaN.F. Umatilla State OregonTract or  
Survey No. \_\_\_\_\_44 73  
Cor. V-11  
No. \_\_\_\_\_

## CORNER DIAGRAM

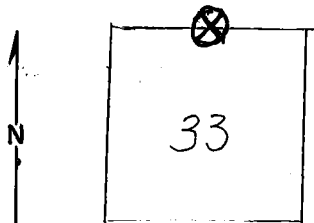

## DESCRIBE CORNER MONUMENT FOUND

Basalt stone, 12"x10"x5". On surface, disturbed, No positive I.D. on markings.

## DESCRIBE BEARING TREES OR OTHER OFFICIAL ACCESSORIES FOUND

P. Pine BT, 20"DBH, N65°W, 30 lks, living, face grown over.  
No scribing visible.  
No evid. of tam. BT.

## PHOTO IDENTIFICATION DATA

Photo No. EQO(9/9/67)25-8

Filed At. \_\_\_\_\_

Object Ident. 24" firIdent. By Tom Sutherland*Signature*

## PLANE COORDINATE POSITION DATA

State \_\_\_\_\_ Zone \_\_\_\_\_

X \_\_\_\_\_

Y \_\_\_\_\_

Estab. By \_\_\_\_\_

*Agency*

## DESCRIBE CORNER LOCATION RELATIVE TO NEAR-BY FEATURES, ALSO HOW TO REACH CORNER

Used topog. map (1964) to ident. area on aerial photo. Found blazed line (painted red) & followed them from NE cor. of sec. 33 to the n 1/4 cor. being searched. Found location poster on W. side of a narrow road 90 ft. east of corner.

Signature  
Ken MagoonTitle  
Eng. AidDivision  
U.S.F.S.; Umatilla N.F.; S.O.

Headquarters \_\_\_\_\_

Date  
17 Sept. 1969

7100-52 (3/68)

5

CORNER RECORD (PERPETUATION)

MONUMENT: DESCRIBE NEW MONUMENT SET, OR WORK DONE TO PRESERVE EXISTING MONUMENT

-----

ACCESSORIES : DESCRIBE NEW BT'S WITNESS OBJECTS ETC. ESTABLISHED, OR WORK DONE TO PRESERVE EXISTING EVIDENCE

Painted BT red.  
Posted location poster on BT (since was out BT signs)  
Posted attention sign.

Work Done By Mike Lilly Title Eng. Aid Date 8/26/69 State Registration No. \_\_\_\_\_  
or Agency \_\_\_\_\_

Certified Cor. Record Prepared ? Yes  No Filed At: \_\_\_\_\_ Date \_\_\_\_\_

REMARKS

Pin pricked 24" fir bearing N6°E, 146 lks. from pine BT.

Index File No. V-11 T. 1 S. 36 E. Willamette M. Tract or Surv. No. \_\_\_\_\_ Cor. V-11