

USDA-FOREST SERVICE

Index File No. P-01

T 15 R. 36 E

Merid. W.M

CORNER RECORD (SEARCH)

(Ref. FSM 7151.4)

Tract or Survey No. \_\_\_\_\_ Cor. No. \_\_\_\_\_

R.D. WALLA WALLA County UMATILLA

N.F. UMATILLA State OREGON

CORNER DIAGRAM

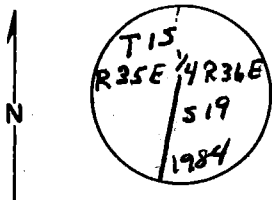

DESCRIBE CORNER MONUMENT FOUND

FND 3/4" BLM BRASS CAP RISING 6" ABOVE GROUND.

DESCRIBE BEARING TREES OR OTHER OFFICIAL ACCESSORIES FOUND

13" W. FIR, BLAZED & SCRIBED 1/4 S 19 BT,  
 BEARS N34°E, 38 LKS., 25.1 FT.  
 15 1/2" SPRUCE, BLAZED & SCRIBED 1/4 S 19 BT,  
 BEARS S42 1/2°E, 67 LKS., 44.2 FT.

PHOTO IDENTIFICATION DATA

Photo No. \_\_\_\_\_

Filed At. \_\_\_\_\_

Object Ident. \_\_\_\_\_

Ident. By \_\_\_\_\_

Signature

PLANE COORDINATE POSITION DATA

State \_\_\_\_\_ Zone \_\_\_\_\_

X \_\_\_\_\_

Y \_\_\_\_\_

Estab. By \_\_\_\_\_

Agency

Signature

*Beaton*

Title LS 1848

Division

Headquarters

Date

7-2-85

FS-7100-52 (3/68)

CORNER RECORD (PERPETUATION)

MONUMENT: DESCRIBE NEW MONUMENT SET, OR WORK DONE TO PRESERVE EXISTING MONUMENT

NONE

ACCESSORIES: DESCRIBE NEW BT'S WITNESS OBJECTS ETC. ESTABLISHED, OR WORK DONE TO PRESERVE EXISTING EVIDENCE

SET STEEL FENCE POST

ATTACHED SIGNS TO POST & BT'S.

Work Done By B.A. SUTTON Title SURVEYOR Date 7-2-85 State Registration No. LS 1848  
or Agency

Certified Cor. Record Prepared? Yes No  Filed At: \_\_\_\_\_ Date \_\_\_\_\_

REMARKS

Index File No.

P-01

T. 15

R. 36 E W.M.

Tract or Surv. No.

Cor.

W 1/4 S 19

Index File No. P -1  
T 1 S. R. 36 E.  
Merid. Willamette

CORNER RECORD (SEARCH)

Tract-or Survey No. \_\_\_\_\_  
Cor. No. P-1 54

R.D. Pendleton County Umatilla  
N.F. Umatilla State Oregon

CORNER DIAGRAM

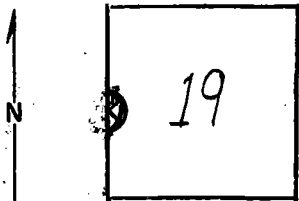

DESCRIBE CORNER MONUMENT FOUND

None found.

DESCRIBE BEARING TREES OR OTHER OFFICIAL ACCESSORIES FOUND

Fir BT, 14" (stump) N. 58° E, 9 links. Only a bark shell left, no wood, no scribing, but blaze is very evident on bark; short blaze at base of stump and the bottom of a larger blaze that was above.  
Tamarack, 10" (stump) N. 85° W, 22 links, rotted, no blaze remains.

PHOTO IDENTIFICATION DATA

Photo No. \_\_\_\_\_  
Filed At. \_\_\_\_\_  
Object Ident. \_\_\_\_\_  
Ident. By \_\_\_\_\_  
*Signature*

DESCRIBE CORNER LOCATION RELATIVE TO NEAR-BY FEATURES, ALSO HOW TO REACH CORNER

Identified search area on photo by projecting N. from the NW corner of Sec. 30, T. 1 S., R. 36 E. Drove to opening west of area. Found an old blaze line running N and S through area. Followed line north to point where hillside changes abruptly to a steep decline. Paced south from breaking point, approx. 8 chains.

PLANE COORDINATE POSITION DATA

State \_\_\_\_\_ Zone \_\_\_\_\_  
X \_\_\_\_\_  
Y \_\_\_\_\_  
Estab. By \_\_\_\_\_  
*Agency*

Signature:  
Ken Magoon

Title  
Engr. Aid

Division  
USFS, Umatilla NF, S.O.

Headquarters

Date  
9/17/69

7100-52  
REV. 65 5



CORNER RECORD (PERPETUATION)

MONUMENT: DESCRIBE NEW MONUMENT SET, OR WORK DONE TO PRESERVE EXISTING MONUMENT

ACCESSORIES : DESCRIBE NEW BT'S WITNESS OBJECTS ETC. ESTABLISHED, OR WORK DONE TO PRESERVE EXISTING EVIDENCE

Posted BT, Attention signs.

Flagged (red ) blazed line.

Work Done By Mike Lilly Title Engr. Aid Date 8/28/69 State Registration No. or Agency \_\_\_\_\_

Certified Cor. Record Prepared ? Yes  (No)  Filed At: \_\_\_\_\_ Date \_\_\_\_\_

REMARKS

Index File No. P-1 T. 1 S. R. 36 E. M. Willamette Tract or Surv. No. \_\_\_\_\_ Cor. P-1