

USDA-FOREST SERVICE

Index  
File No. L-25  
T 1S R. 36E  
Merid. Willamette

CORNER RECORD (SEARCH)

(Ref. FSM 7151.4)

R.D. Walla Walla County Umatilla  
N.F. Umatilla State Oregon

Tract or  
Survey No. \_\_\_\_\_  
Cor. No. \_\_\_\_\_

CORNER DIAGRAM

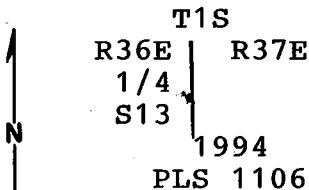

DESCRIBE CORNER MONUMENT FOUND

None.  
This corner was re-established by single proportionate measurement, using U.S. Deputy Surveyor, Henry Meldrum's record, under GLO contract no. 450, dated 6/11/1882.

DESCRIBE BEARING TREES OR OTHER OFFICIAL ACCESSORIES FOUND

None.

PHOTO IDENTIFICATION DATA

Photo No. \_\_\_\_\_  
Filed At. \_\_\_\_\_  
Object Ident. \_\_\_\_\_  
Ident. By \_\_\_\_\_  
*Signature*

DESCRIBE CORNER LOCATION RELATIVE TO NEAR-BY FEATURES, ALSO HOW TO REACH CORNER

Corner is at base of basalt outcropping (covered with moss and lichens) on extremely steep North slope.

PLANE COORDINATE POSITION DATA

State \_\_\_\_\_ Zone \_\_\_\_\_  
X \_\_\_\_\_  
Y \_\_\_\_\_  
Estab. By \_\_\_\_\_  
*Agency*

*Signature*  
Wallis R. Wells

Title  
PLS

Division

Headquarters  
PENALETON

Date  
10/10/94

FS-7100-52 (3/68)

CORNER RECORD (PERPETUATION)

MONUMENT: DESCRIBE NEW MONUMENT SET, OR WORK DONE TO PRESERVE EXISTING MONUMENT

Set a 2 1/2" aluminum cap on a 2 1/2" x 30" aluminum pipe, 20" in the ground with a mound of stone to cap, marked as shown in diagram. Set steel fence post with 54-9 sign, 2.0 feet North of monument.

ACCESSORIES : DESCRIBE NEW BT'S WITNESS OBJECTS ETC. ESTABLISHED, OR WORK DONE TO PRESERVE EXISTING EVIDENCE

A 14" douglas fir bears N10°W-35.3 feet, scribed: 1/4 S13 BT.  
A 15" douglas fir bears N17°W-37.6 feet, scribed: 1/4 S13 BT.  
An 8" white fir bears N72°W-55.0 feet, scribed: 1/4 S13 BT.  
An XBO on base of 1' x 2' x 1' moss covered basalt outcropping, bears N86°W-17.6 feet, to the 'X'. New bearing trees have a brass washer stamped 'PLS 1106' nailed to the face of blaze. Attached 54-3 and 54-9 signs, painted 6" red band and face of blaze red.

Work Done By. WR Wells Title PLS Date \_\_\_\_\_ State Registration No. PLS 1106  
or Agency \_\_\_\_\_  
Certified Cor. Record Prepared ? Yes  No \_\_\_\_\_ Filed At: UMATILLA COUNTY SURVEYORS OFFICE Date 12/94

REMARKS

This corner was monumented as part of USFS contract.

Index File No. T. R. M. Tract or Surv. No. Cor. 12  
L25 1S 36E Willamette 13

Index

File No. L-25

**CORNER RECORD (SEARCH)**

(Ref. FSM 7151.4)

Tract or Survey No. \_\_\_\_\_ Cor. No. L-25

T 1S R. 36E

R.D. Pendleton County Umatilla

Merid. Willamette

N.F. Umatilla State Oregon

**CORNER DIAGRAM**

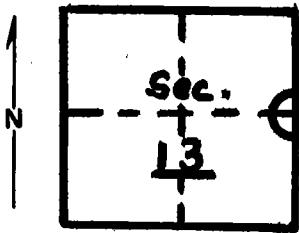

**DESCRIBE CORNER MONUMENT FOUND**

Material: None

2

**DESCRIBE BEARING TREES OR OTHER OFFICIAL ACCESSORIES FOUND**

Ran compass line from brass cap. Searched 200' south of east Meacham Creek. All trees in search area down and very rotten. Found what could have been a blaze on one of them but no solid wood.

3

**DESCRIBE CORNER LOCATION RELATIVE TO NEAR-BY FEATURES, ALSO HOW TO REACH CORNER**

4

**PHOTO IDENTIFICATION DATA**

Photo No. \_\_\_\_\_  
 Filed At. \_\_\_\_\_  
 Object Ident. \_\_\_\_\_  
 Ident. By \_\_\_\_\_  
 Signature \_\_\_\_\_

6

7

**PLANE COORDINATE POSITION DATA**

State \_\_\_\_\_ Zone \_\_\_\_\_  
 X \_\_\_\_\_  
 Y \_\_\_\_\_  
 Estab. By \_\_\_\_\_  
 Agency \_\_\_\_\_

8

Signature  
 Bill Moore

Title  
 Eng. Tech.

Division \_\_\_\_\_ Headquarters \_\_\_\_\_

Date  
 6/77

7100-52-(3/68)

5

CORNER RECORD (PERPETUATION)

GPO 902-673

MONUMENT: DESCRIBE NEW MONUMENT SET, OR WORK DONE TO PRESERVE EXISTING MONUMENT

9

ACCESSORIES : DESCRIBE NEW BT's WITNESS OBJECTS ETC. ESTABLISHED, OR WORK DONE TO PRESERVE EXISTING EVIDENCE

10

Work Done By \_\_\_\_\_ Title \_\_\_\_\_ Date \_\_\_\_\_ State Registration No.  
or Agency \_\_\_\_\_

Certified Cor. Record Prepared ? Yes No Filed At: \_\_\_\_\_ Date \_\_\_\_\_

11

REMARKS

12

Index File No. T. R. M. Tract or Surv. No. Cor. 13