

U. S. Department of Agriculture
FOREST SERVICE

Umatilla NATIONAL FOREST

CORNERS OF THE PUBLIC SURVEY

T. 1 S. R. 35 E. Wm. Mer.

Section 31 Corner common to Sections 25 and 36

Corner consists of a BT ~~(Rock)~~ in place
State condition 10' snag, rotted.

Dimensions above ground 24" inches.

Sketch grooves, letters, figures, or notches, on proper face or edge.

CARDINAL POSITION

DIAGONAL POSITION

N W S E NW SW SE NE

Mound of _____ is located _____

Pits are located _____

Sketch markings of Bearing Trees (or Rocks) in proper box and fill blanks below, giving bearings from Corner to Trees and Distances in Links.

<u>1 S</u>			
<u>R 35 E</u>			
<u>S 25</u>			

Species Fir

Diameter 24"

Bearing _____

Distance _____

Do you believe this to be a genuine Land Office Corner? _____

If not, why? Yes, original scribing.

Joe Gertson
(Signature) NFD
(Title)

7/12/51
(Date)

T. _____ R. _____ Mer. _____

(Make sketch of topography near Corner and show section line markers thus "X")

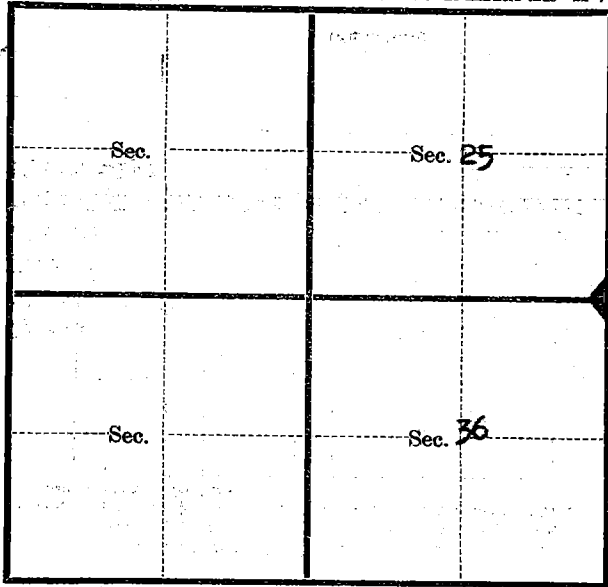

Metal Location Poster is on a White fir
tree 6" inches diameter, on the _____

side of _____ from which
this Corner bears _____ Chains.

(Bearing) (Distance)

Section line marker between Secs. _____ and _____ is on

a _____ on the _____
(Tree, post, etc.) (Name of road, trail, etc.)

located _____ chains E, W, N, S, from Sec. Cor.; 1/4 Cor.; Witness Cor.
(Cross out nonapplicable)

Give any further facts needed to find Corner again:

N - S line blazed.

USDA-FOREST SERVICE

Index
File No. V-25

CORNER RECORD (SEARCH)
(Ref. FSM 7151.4)

Tract or Survey No. 0 Cor. No. V-25

T 1S R. 35E R.D. _____ County _____

Merid. _____ N.F. _____ State _____

CORNER DIAGRAM

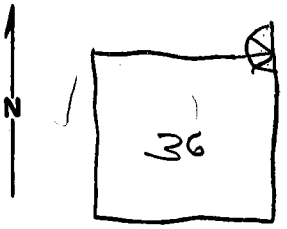

DESCRIBE CORNER MONUMENT FOUND

Set $\frac{3}{16}$ " x 3" x 20" Iron Plate, 18" in ground
Gibson - 11/69. (for Ore. State Forestry Dept.)

DESCRIBE BEARING TREES OR OTHER OFFICIAL ACCESSORIES FOUND

Old and new B.T.'s.

PHOTO IDENTIFICATION DATA

Photo No. _____
Filed At. _____
Object Ident. _____
Ident. By _____
Signature

DESCRIBE CORNER LOCATION RELATIVE TO NEAR-BY FEATURES, ALSO HOW TO REACH CORNER

Set 4" x 4" x 72" White Painted Cedar Post
1 ft. NW of Corner.

PLANE COORDINATE POSITION DATA

State _____ Zone _____
X _____
Y _____
Estab. By _____
Agency

Signature
TGH

Title _____ Division _____ Headquarters _____

Date 2-8-79 7100-52-(3/68)

6

7

8

2

3

4

5

CORNER RECORD (PERPETUATION)

MONUMENT: DESCRIBE NEW MONUMENT SET, OR WORK DONE TO PRESERVE EXISTING MONUMENT

9

ACCESSORIES : DESCRIBE NEW BT's WITNESS OBJECTS ETC. ESTABLISHED, OR WORK DONE TO PRESERVE EXISTING EVIDENCE

10

Work Done By _____ Title _____ Date _____ State Registration No. _____
or Agency _____

Certified Cor. Record Prepared ? Yes No Filed At: _____ Date _____

11

REMARKS

12

Index File No. _____ T. _____ R. _____ M. _____ Tract or Surv. No. _____ Cor. _____
U.S. G.P.O. 1977-725-576/586

13

LAND CORNER RECORD

LL 5680-2

(Rectangular)

1. T 15 R 35E No. V-25 Cor. Sec. Mer. Will State Oregon N. F. Umatilla Dist. Pend 3

2. Corner Status

3. Original Description GLD Vol. _____ Page _____ Where Recorded BLM

4. Description of Corners: 4" Post

Fir 24"	S10°W	26 Lks
horeh 12"	S63°E	23 "
" 24"	N22°E	28 "
Fir 24"	N84°W	20 "

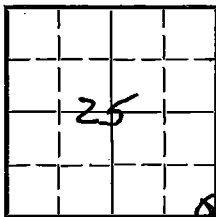

5. Investigation Notes:

10" snag Rotted 24" above Ground^v
 Fir B.T. 24" scribbing visible

7. Photo Identification

Photo No. _____

Ident. By: _____

8. Plane Coordinate Position Data

State _____ Zone _____

X _____

Y _____

Estab. By _____

Field Book No. _____

Where Filed _____

9. Evaluation

Authentic _____

Needs Verif. X Monument NO

Re-estab. _____ Survey _____

Land Status _____

6. Signed Joe Garton Title D. R. Date 7-12-51

PERPETUATION RECORD

10. Monument:

11. Accessories

12. Set By _____ Title _____
License _____ Agency _____ Date _____

Field Book _____ Page _____
13. Recorded By _____ Volume _____ Page _____
(Agency)
(Date) (City) (County) (State)

14. Remarks:

V-25