

RESTORED CORNER FOR STATE OF OREGON--DEPARTMENT OF FORESTRY

History of original corner establishment:

Closing corner common to Sections 25 and 36 (East end), T1S, R35E, W.M., Umatilla County, Oregon.

ORIGINAL (1882) and evidence FOUND

Post (hole containing rotted wood found in place) from which a:

8" Fir bears S56E 10 lks.; burned out stump hole in place.

4" Fir bears N42W 25 lks.; remains of burnt wood and stump hole found in place.

7" Fir bears S50W 24 lks.; now 12", rotted to ground level. Section corner 30 and 31 bears North 355.1 ft.

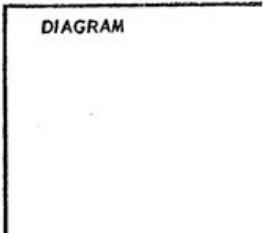

~~Description of corner evidence found:~~

Description of monument and accessories established to perpetuate the original location of this corner
RESTORED

Set 3/16" x 3" x 20" iron plate, 18 inches in ground, and from which a:

13" Fir bears S23W 44.5 ft. to face; scribed T1S R35E S36 BT RS359.

14" Fir bears N39W 75.8 ft. to face; scribed T1S R35E S25 BT.

Set 4 x 4 x 72" white painted Cedar post 1.0 ft. NW of corner plate. Oregon State Forestry Department metal location poster on 12" Tamarack N52W 11.8'. Also Forest Service poster on same tree.

Dated September 17, 1969

Restored by

Present and witnessed by Frank Blizard

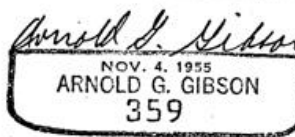
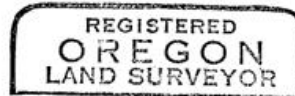

Office of.....County.....Surveyor..... County of.....Umatilla.....
State of.....Oregon....., I hereby certify that the within instrument was filed in this office
for record on the 4 day of November, 1969, at..... o'clock.....m., (signed)
Ralph Thompson by.....
(COUNTY OFFICIAL) (DEPUTY)

Q-881

RESTORED CORNER FOR STATE OF OREGON--DEPARTMENT OF FORESTRY

History of original corner establishment:

Closing corner common to Sections 25 and 36 (East end), T1S, R35E, W.M., Umatilla County, Oregon.

ORIGINAL (1882) and evidence FOUND

Post (hole containing rotted wood found in place) from which a:

- 8" Fir bears S56E 10 lks.; burned out stump hole in place.
 - 4" Fir bears N42W 25 lks.; remains of burnt wood and stump hole found in place.
 - 7" Fir bears S50W 24 lks.; now 12", rotted to ground level.
- Section corner 30 and 31 bears North 355.1 ft.

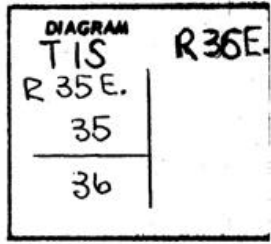

Description of corner evidence found--

APPEARS TO BE

T 1 S

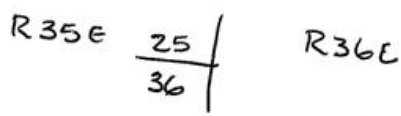

Description of monument and accessories established to perpetuate original location of this corner
RESTORED

Set 3/16" x 3" x 20" iron plate, 18 inches in ground, and from which a:

- 13" Fir bears S23W 44.5 ft. to face; scribed T1S R35E S36 BT RS359.
- 14" Fir bears N39W 75.8 ft. to face; scribed T1S R35E S25 BT.

Set 4 x 4 x 72" white painted Cedar post 1.0 ft. NW of corner plate. Oregon State Forestry Department metal location poster on 12" Tamarack N52W 11.8'. Also Forest Service poster on same tree.

Dated September 17, 1969

Restored by

Present and witnessed by Frank Blizard



Arnold G. Gieson
 NOV. 4, 1955
 ARNOLD G. GIESON
 359

Office of..... County of.....
 State of....., I hereby certify that the within instrument was filed in this office
 for record on the..... day of....., 19....., at..... o'clock.....m., (signed)
 (COUNTY OFFICIAL) by..... (DEPUTY)