

RESTORED CORNER FOR STATE OF OREGON--DEPARTMENT OF FORESTRY

History of original corner establishment:

One quarter corner common to Sections 25 and 36, T1S, R35E, W.M., Umatilla and Union Counties, Oregon.

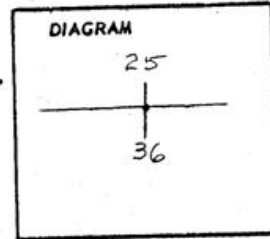

ORIGINAL (1882) and evidence FOUND

Post (missing, 2" by 3 ft. stake found in place) from which a:

- 6" Fir bears N10E 12 lks.; rotted roots remaining.
- 14" Fir bears S21W 13 lks.; now 24" White Fir, scribes  $\frac{1}{4}$ S BT visible.
- Line blazes found East, West and South.

~~Description of corner evidence found.~~

Description of monument and accessories established to perpetuate the original location of this corner

RESTORED

Set 1 1/2" x 36" galvanized iron pipe with 3" bronze cap marked "OREGON STATE BOARD OF FORESTRY  $\frac{1}{4}$  S25 S36 1969 RS359", 30 inches in ground, in mound of rock, and from which a:

- 24" Doug. Fir bears S10W 19.2 ft. to face; scribed  $\frac{1}{4}$  S36 BT RS359.
- 10" Tamarack bears N24E 50.8 ft. to face; scribed  $\frac{1}{4}$  S25 BT.

Set 4 x 4x72" white painted Cedar post 1.0 ft. SW of corner pipe. Oregon State Forestry Department metal location poster on 10" Tamarack BT. Also Forest Service poster on 24" White Fir BT.

Dated September 17, 1969

Restored by

Present and witnessed by Frank Blizard

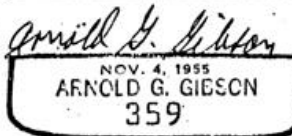
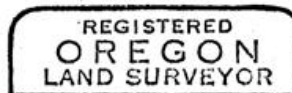

Office of ..... County of .....

State of ....., I hereby certify that the within instrument was filed in this office for record on the ..... day of ..... 19....., at ..... o'clock .....m., (signed) .....

(COUNTY OFFICIAL) by (DEPUTY)

Form R6-7100-57 (9/66)

RECEIVED BY  
 Umatilla County Surveyor  
 Date 12-89  
 No. 89-118-R

RECEIVED BY  
 Umatilla County Surveyor