

N-17

OREGON CORNER RESTORATION FORM

Section 14 Township 1 S. Range 35 E.

County UMATILLA Date 10-1-93

Corner Designation

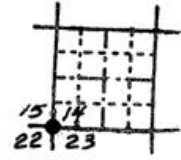

- Condition Report Only
- Not Found
- Renewed
- Unrecorded
- Surveyed In
- Referenced Out

Previous Renewals/Surveys, etc. G.L.O. survey of 1881, "set post, 4 ft. long, 4 ins. sq., 24 ins. in ground" and marked 4 B.T.'s

Monument(s) & Accessories Found: (Condition and Source)

Found original G.L.O. post, very deteriorated, appeared to be about 3" dia. round pointed stake. The bottom of the stake was 2.3' below old surface (marked by layer of charcoal). Found 26" fir stump with face scribed "BT". S 75° W 17.1' (G.L.O.- 10" fir S 77° W 17.2'). Found remains of rotted fir and back cast with scribs N 55° W 17.6' (G.L.O.- 5" fir N 53° W 17.8'). The other two G.L.O. trees fell in an area that appears to have been cleared with a cat. Found old tree tag on 24" fir snag N 74° W 11.1' marked "S 53 E 19".

Monument Detail



Sketch

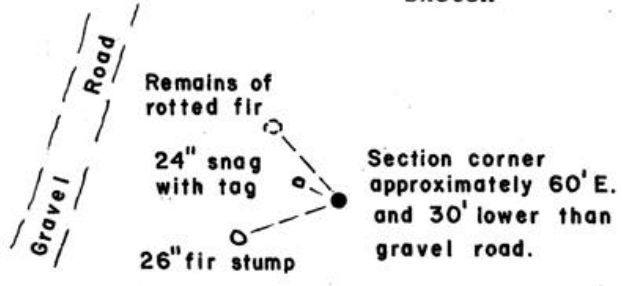

Monument Set (Procedures and Description)

Set 1" x 30" iron pipe with 2 3/8" brass cap marked as shown, in place of original post.

New Accessories

Marked new B.T.'s with "OREGON STATE PARKS" tree tags as follows:

24" fir snag N 74° W 11.1'

4" Pine N 26° E 2.6'

5" Pine S 46° E 9.9'

5" Pine S 38° W 10.3'

Location & Comments

Surveyor's Seal

Compass Declination 20° E

Firm/Agency Oregon State Parks and Recreation Dept.

Address 525 SE Trade St. Salem, OR 97310

Party Chief Russ Pinard

Notes Dean Timmerman

Witness Harold Hanson

REGISTERED PROFESSIONAL LAND SURVEYOR

Russell T. Pinard

OREGON
JULY 16, 1971
RUSSELL T. PINARD
958

Expires 12-31-94

RECEIVED BY
Umatilla County Surveyors
Date 12-93
Rec'd By [Signature]
No. 73-116-R