

OREGON CORNER RESTORATION FORM

COUNTY: Umat la DATE: 8/10/95

CORNER DESIGNATION: N-11. South 1/4 corner Section 16, T1S., R35E., W.M.

PREVIOUS RENEWALS/SURVEYS, ETC.: Corner originally established by U.S. Deputy Surveyor Rufus S. Moore under Contract No. 451 dated June 12, 1882. The Surveyor General records state: Set post, 3 ft. long, 3 ins. sq., 24 ins. in ground, for 1/4 Sec. Cor., 100 ft. above bed of creek, marked 1/4 S. on N. face, from which,

A pine, 24 ins. diam., brs. N.53°W., 126 lks. dist., marked 1/4 S., B.T.

A pine, 20 ins; diam., brs.S.20°E., 25 lks. dist., marked 1/4 S., B.T.

Corner recovered by U.S. Deputy Surveyors Currin & Noland under Special Contract dated May 4, 1887. Corner recovered by Manius Buchanan under Contract #635 dated April 19, 1895. Corner was recovered and remonumented in 1974, Survey No. J-77.

MONUMENT AND ACCESSORIES FOUND: Found a leaning 2 1/2" brass cap on a 2" galvanized iron pipe, in mound of stone. Recovered monument is a standard Bureau of Indian Affairs monument, marked as shown in Monument Marking Detail.

From the recovered monument:

Rotted pine stump remains bear S 20° E, 16.5 feet. (original bearing tree).

A 25" ponderosa pine bears N 51 1/2° W, 83.8 feet with healed double blaze. (original bearing tree).

MONUMENT MARKING DETAIL:

S | 21
S | 16
1/4 S
1S R35E
1974 RLS 933

*Note: Section Numbers are switched on brass cap.

MONUMENT SET:

At the exact position of the existing monument, set a 5/8" x 30" iron pin with yellow plastic cap marked "OR PLS 1106 WA PLS 17372", 20" in ground and surrounded with mound of earth and stone. Placed LS 933 monument horizontally, South of new monument. The iron pin monument was set because of shallow rock conditions.

New bearing trees:

A 8" ponderosa pine bears N 11° E, 70.6 feet, scribed "1/4 S 16 BT".

A 9" ponderosa pine bears S 10 1/2° W, 47.8 feet, scribed "1/4 S 21 BT".

A 9" pondersa pine bears S 70 1/2° W, 20.4 feet, scribed "1/4 S 21 BT".

Set steel fence post 2 feet South of corner with witness sign attached.

LOCATION & COMMENTS:

Original monument had been pushed over by logging activity, but it's original position could be determined with reference to the original monument, stone mound and original bearing trees.

COMPASS DECLINATION: 18° East.

Surveyor's Seal

FIRM/AGENCY: William R. Wells, PLS
P.O. Box 1696
Pendleton, Oregon 97801

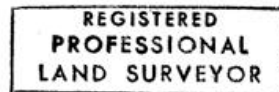

Party Chief: William R. Wells, PLS
Notes: Rodney Lewis, LSIT

Umatilla County Surveyor
Date 10-95
Rec'd by KK
No. 95-168-B



renews 6-30-96