

OREGON CORNER RESTORATION FORM

Section 9 Township 1S Range 34
 County Umatilla Date: June 25, 1998

Corner Designation: 1S34J9

Section Corner common to Sections 8, 9, 16 and 17.
 T1S, R34E, W.M.

Condition Report Only
 Not found
 Remonumented
 Unrecorded
 Surveyed in
 Referenced out

Previous Renewals / Surveys, etc.

Corner originally established by Currin and Nolan in 1889 under special contract dated May 4, 1889. They set a 16x10x8 ins. stone 10 ins. in ground for cor. to secs. 8, 9, 16 & 17, marked 4 notches on S. & 4 notches on E. edges and raised a mound of stone around it. Their notes called for a draw bottom 0.75 chains east and a ridge top trail 10.5 chains north.

Monument and Accessories found: (condition and source)

Found a mound of stones with an unmarked record size stone at the record call distances from the draw bottom and the trail.

DIAGRAM

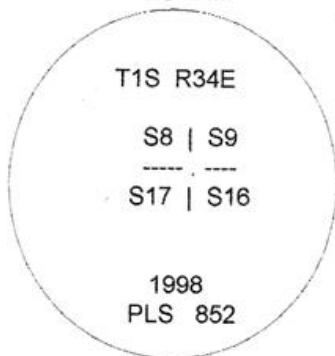

SKETCH

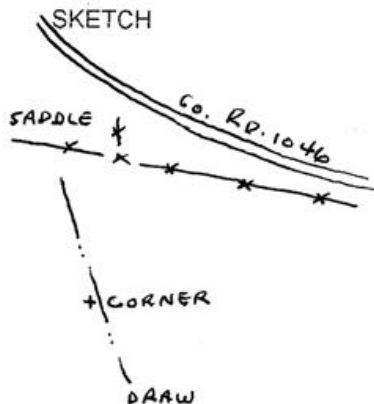

MONUMENT (S) AND ACCESSORIES SET (Procedures and Description)

Set a 1.5 " x 30" galvanized iron pipe with 2 1/2" brass cap 29" in the ground stamped as shown in the diagram above. Buried corner stone alongside.

REFERENCES SET:

Set 4 - 5/8" x 24" rebars with 2 3/8" red plastic caps marked ORLS 0852 and WALS 13922 for references as follows:

N10°07'E, 48.80 feet

N86°35'E, 53.44 feet

S10°27'W, 44.95 feet

N76°32'W, 42.17 feet

Set a steel fence post along side with a Umatilla County Survey Monument sign attached.

Location and comments

The corner may be reached by following County Road 1046 west through the Skillman gate 0.6 mile. Cross over a low saddle to the south and go down a draw 700 feet.

Compass Declination
 Bearings are true.

Firm / Agency
 Haddock Surveying
 Address
 P.O. Box 1574
 Pendleton, Or. 97801
 Party Chief
 David L. Haddock

Surveyors Seal

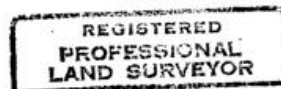

David L. Haddock

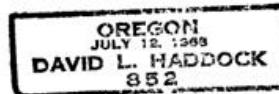

RECEIVED BY:

Umatilla County Surveyor
 Date: 7-98
 Rec'd By: KK
 No. 98-124-R