

**OREGON CORNER RESTORATION FORM**

COUNTY: Umatilla DATE: 9/15/94

CORNER DESIGNATION: A-21. Northeast corner Section 2, T1S., R34E., W.M.

PREVIOUS RENEWALS/SURVEYS, ETC.: Most recent approved GLO Survey was made by James P. Currin and James Noland, under Special Contract dated May 4, 1887. Notes state: "Set post 4 ft. long, 4 ins. sq., 2 ft. in ground, for Closing Cor. to Secs. 1 & 2, marked, T.1 S., S.1 on S.E. face, R.34 E., S.2 on S.W. face, one notch on E. and 5 notches on W. edges, from which, A fir, 12 ins. diam., brs. S.46° E., 30 lks. dist., marked T. 1 S., R.34 E., C.C., B.T. A tamarack, 16 ins. diam., brs. S. 70° W., 58 lks. dist marked T.1 S., R.34 E., S.2, C.C., B.T."

MONUMENT AND ACCESSORIES FOUND: Found 30" tamarack snag with visible scribing at S 70° W-58 links (38.3 feet), did not find post or 12" fir at S 46° E-30 links. Re-established corner position at N 70° E-38.3' from centerline of tamarack snag.

**MONUMENT MARKING DETAIL:**

T1N R34E  
CC  
-----  
S2 | S1  
T1S R34E  
1994  
PLS 1106

MONUMENT SET: At re-established corner position set a 2 1/2" brass cap on a 1 1/4" x 30" galvanized iron pipe, 24" in the ground, with mound of stone to cap, (marked as shown in the monument detail).

**New Accessories:**

Set steel fence post 2.0 feet North of monument, with witness sign attached.  
A 15" douglas fir bears S 34° E-52.2 feet, scribed: T1S R34E S1 CC BT.  
A 14" douglas fir bears S 08° E-34.3 feet, scribed: T1S R34E S1 CC BT.  
A 6" white fir bears S 27° W-24.0 feet, scribed: T1S R34E S2 CC BT.  
A 4 1/2" white fir bears S 81 1/2° W-8.1 feet, scribed: "X" at breast height and "BT" at base of tree.  
Bearing trees have a brass washer stamped 'PLS 1106' nailed to the face of the blaze. Attached bearing object and witness signs to each tree; painted a 6" band and face of blaze red.

**LOCATION & COMMENTS:**

STATE PLANE CO-ORDINATE:  
Oregon North Zone, NAD 83/91., U.S. Survey Foot:  
N = 680188.90  
E = 8712365.14

COMPASS DECLINATION: 18° East.

Surveyor's Seal

FIRM/AGENCY: William R. Wells, PLS  
P.O. Box 1696  
Pendleton, Oregon 97801

Party Chief: Robert D. English  
Notes: Robert D. English  
Witness: F. Scot Munro

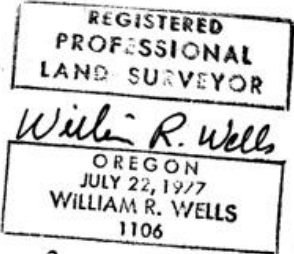

RECEIVED BY  
Umatilla County Surveyor  
Date 2-95  
Rec'd By KK  
No. 95-16-C

Renews 6/30/96