

OREGON CORNER RECORATION FORM

Section 3 Township 1S Range 32E
 County Umatilla Date: April 7, 1999

Corner Designation: 1S32C17

1/4 corner to sections 2 and 3, T1S, R32E W.M.

Condition Report Only
 Not found
 Remonumented
 Unrecorded
 Surveyed in
 Referenced out

Previous Renewals / Surveys, etc.

Corner originally set by Daniel Chaplin under contract No. 107 Dated September 21, 1864.
 His record reads: Set post for 1/4 section corner in mound of earth with charred stake, pits, etc., as per instructions.

Monument and Accessories found: (condition and source)

Found a fence intersection with fences running north, south, and west. The fence corner falls 3.47' north and 0.34' west of the proportioned point for the corner.

DIAGRAM

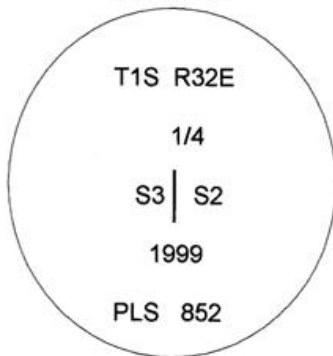

SKETCH

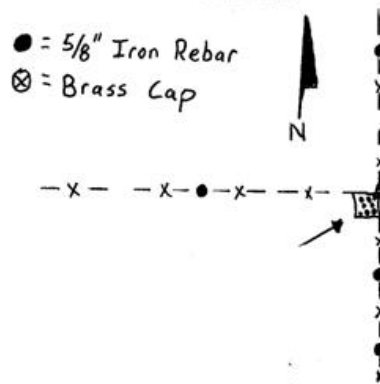

MONUMENT (S) AND ACCESSORIES SET (Procedures and Description)

Set a 1 1/4" x 30" Galvanized Iron Pipe with a 2 1/2" brass cap stamped as shown in the diagram above at the fence intersection.

For references, I set four 5/8" by 24" rebars with 1.25" red plastic caps stamped ORLS 852 and WALS 13922 as described below:

- an iron rebar bears N0°26'W, 60.90 feet in the existing fence;
- an iron rebar bears N88°22'W, 91.59 feet in the existing fence;
- an iron rebar bears S1°09'W, 22.96 feet in the existing fence;
- an iron rebar bears S0°23'W, 69.53 feet in the existing fence;

This monument and references were set and tied used a LIECA system 300 RTK GPS

Location and comments

Compass Declination

Surveyors Seal

RECEIVED BY:
 Umatilla County Surveyor
 Date: 4-99
 Rec'd By: KK
 No. 99-59-B

Firm / Agency
 Haddock Surveying
 Address
 P.O. Box 1574
 Pendleton, Or. 97801
 Party Chief
 Stephen K, Haddock

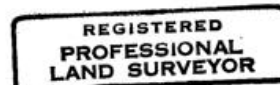

David L. Haddock

