

OREGON CORNER RESTORATION FORM

Section 2 Township 1S Range 31E
 County Umatilla Date: October 3, 2001

Corner Designation: 1S31A17

North section corner to sections 2 and 3, T1S, R31E,
 W.M., Umatilla County, Oregon.

Condition Report Only
 Not found
 Remonumented
 Unrecorded
 Surveyed in
 Referenced out

Previous Renewals / Surveys, etc.

The corner was originally set by David P. Thompson under contract No. 106 dated August 16, 1864. His record reads: Set post for corner to secs. 2 & 3 in mound of earth with charred stake, pits, trench, and C. as per instructions. The County surveyor, Aubrey Perry, records a "fence running south - Rock 12" x 9" 6" " in his survey recorded in Book 2, Page 301 of the Record of Private Surveys dated March, 1919.

Monument and Accessories found: (condition and source)

A fence corner with fences running East, West and South with many loose stones from a decayed rock Jack.

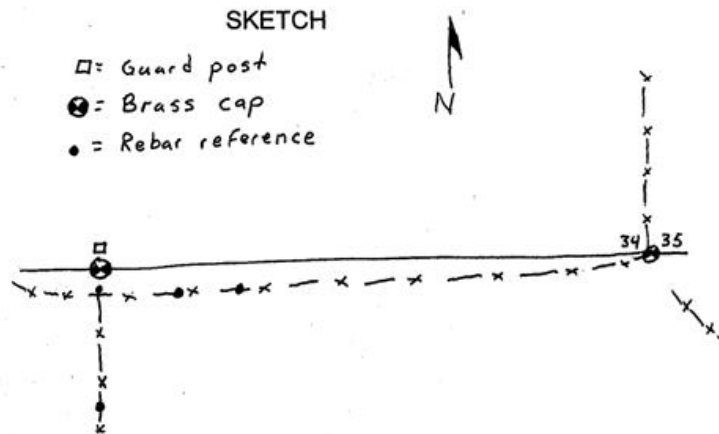
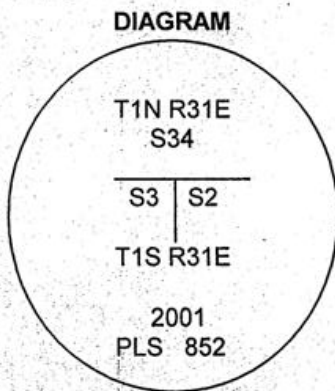

MONUMENT (S) AND ACCESSORIES SET (Procedures and Description)

I held the longitude of the fence running South and proportioned the latitude based on the nearest corners to the East and West. At the point I set a 30" x 1 1/8" G.I.P. with a 2 1/2" brass ca stamped as shown in the diagram above flush with the ground. I set a 5' steel guard post with a County monument sign attached along side.

For references, I set four 5/8" by 24" rebars with 1 1/4" red plastic caps stamped ORLS 852, and WALS 13922 as described below:

- an iron rebar bears S4°07'46"W, 6.49 feet, at the existing fence corner;
- an iron rebar bears S0°24'10"E, 33.44 feet, under the existing fence;
- an iron rebar bears S73°58'22"E, 23.85 feet, under the existing fence;
- an iron rebar bears S83°51'36"E, 51.54 feet, under the existing fence;

The monument and references were tied using a LIECA SYSTEM 300 RTK GPS.

Location and comments
 OR SPC Oregon North 1983-91
 N = 678031.49
 E = 8608356.44

Compass Declination

Surveyors Seal

RECEIVED BY:
Umatilla County Surveyor
 Date: 12/29/2001
 Rec'd By: DHK
 No. 01-206-C

Firm / Agency
 Haddock Surveying
 Address
 P.O. Box 1574
 Pendleton, Or. 97801
 Party Chief
 Stephen K, Haddock



David L. Haddock



RENEWS 6-30-03