

USDA-FOREST SERVICE

Index
File No. Z-25

CORNER RECORD (SEARCH)

(Ref. FSM 7151.4)

Tract or Survey No. _____ Cor. No. _____

T IN R. 37E

R.D. WALLA WALLA County UMATILLA-UNION Co. LINE

Merid. WILLAMETTE

N.F. UMATILLA State OREGON

CORNER DIAGRAM

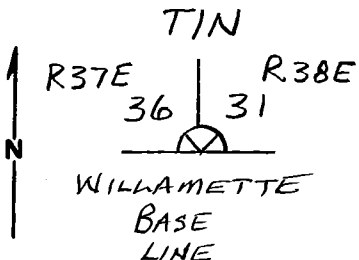

DESCRIBE CORNER MONUMENT FOUND

NONE

DESCRIBE BEARING TREES OR OTHER OFFICIAL ACCESSORIES FOUND

ORIG. 5" SPRUCE IS AN 18" LODGEPOLE PINE SNAG WITH DOUBLE HEALED BLAZES, I DO NOT OPEN. BEARS N60°W, 40.3 FT.

ORIG. 12" SPRUCE IS A 14" LODGEPOLE PINE SNAG WITH DOUBLE OPEN BLAZES, NO SCRIBING DISCERNABLE ON UPPER BLAZE, "B.T" ON LOWER BLAZE IS VERY DISTINCT.

DESCRIBE CORNER LOCATION RELATIVE TO NEAR-BY FEATURES, ALSO HOW TO REACH CORNER

BEARS S45°W, 13.2 FT. ORIG. NE BT IS GONE, CORNER IS 1600 FT WEST OF RD 31. PUT 54-3 & 54-4 SIGNS ON BOTH & A "K" TAG ON SUMMIT RD.

PHOTO IDENTIFICATION DATA

Photo No. _____
Filed At. _____
Object Ident. _____
Ident. By _____

Signature

PLANE COORDINATE POSITION DATA

State _____ Zone _____
X _____
Y _____
Estab. By _____

Agency

Signature

Title

Division

Headquarters

Date

7100-52-(3.68)

Dennis L. Gaylord PLS 1636

9/30/81

CORNER RECORD (PERPETUATION)

MONUMENT : DESCRIBE NEW MONUMENT SET, OR WORK DONE TO PRESERVE EXISTING MONUMENT

ACCESSORIES : DESCRIBE NEW BT'S WITNESS OBJECTS ETC. ESTABLISHED, OR WORK DONE TO PRESERVE EXISTING EVIDENCE

Work Done By _____ Title _____ Date _____ State Registration No. _____
or Agency _____
Certified Cor. Record Prepared ? Yes No Filed At _____ Date _____

REMARKS

Index File No. T. R. M. Tract or Surv. No. Cor.

Index
File No. Z-25 (Z-1)

CORNER RECORD (SEARCH)
(Ref. FSM 7151.4)

Tract or Survey No. _____
Cor. No. _____

T 1N R. 37E (38E) R.D. WALLA-WALLA County Umatilla-Union County Line
Merid. Willamette N.F. Umatilla State OREGON

CORNER DIAGRAM

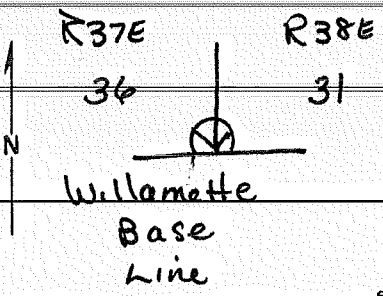

DESCRIBE CORNER MONUMENT FOUND

None

PHOTO IDENTIFICATION DATA

Photo No. _____
Filed At. _____
Object Ident. _____
Ident. By _____
Signature

DESCRIBE BEARING TREES OR OTHER OFFICIAL ACCESSORIES FOUND

Orig. 5" spruce is an 18" LPP snag w/ double heeled blazes. I do not open. Brs. N60°W, 40.3ft.
Orig. 12" spruce is a 14" LPP snag with double open blaze. No scribing discernable on upper blaze, "BT" on lower blaze is very distinct. Bears S45°W, 13.2ft
Orig. NE BT is gone.

PLANE COORDINATE POSITION DATA

State _____ Zone _____
X _____
Y _____
Estab. By _____
Agency

DESCRIBE CORNER LOCATION RELATIVE TO NEAR-BY FEATURES, ALSO HOW TO REACH CORNER

Corner is 1600ft west of Rd. 31. Put 54-3 + 54-4 signs on both & R tag on Summit Rd.

Signature
Dennis L. Gaylord

Title PLS 1636 Division Umatilla NF Headquarters 9/30/81 Date 7100-52-(3,68)