

CERTIFIED RECORD OF LAND CORNER MONUMENTATION

History of original corner establishment:
Corner not previously established.

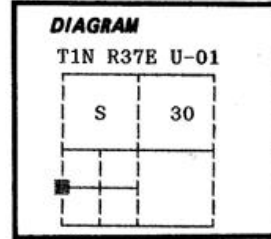

No record of subsequent monumentation found in Umatilla County survey records.

Description of corner evidence found:

Corner not previously established.

See map of survey dated September, 1989.

Description of monument and accessories I established to perpetuate the

original location of this corner: At position determined by survey, I set a 2 1/2" x 30" aluminum pipe with aluminum cap marked as shown, 30 inches in the ground, from which:

New Bearing Trees:

- A 10 inch diameter Douglas Fir bears S33°E, 16.80 feet marked S1/16 S30 BT
- A 13 inch diameter Douglas Fir bears S12°W, 50.5 feet marked S1/16 S25 BT

Painted a 6 inch red band around all BTs and attached bearing tree and land survey monument signs.

Set a steel fence post approximately 5 feet South with Land Survey Monument and Property Boundary signs attached.

I hereby certify that the above corner point was perpetuated as hereon described on September 12, 1989.

Witness: Jeff Petersen.

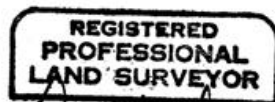

I used a steel tape and magnetic compass in the establishment of new accessories. I used 17° East magnetic declination and the distances are to a 50d spike driven in the right side of the root crown. I attached a brass washer marked OPLS 644 to the BT blaze.

Office of Gr Survey Dept County of Umatilla
 State of OR, I hereby certify that the within instrument was filed in this office
 for record on the 27th day of October, 1989
David H. Anderson by Patricia Ann Knutson
 (COUNTY OFFICIAL) (DEPUTY)

RECEIVED BY

Umatilla County Surveyor

Date 10-89
 Rec'd by KA
 No. 89-101-B

Form R6-7100-57 (9/71)

*GPO-591-971, 1988