

**CERTIFIED RECORD OF LAND CORNER MONUMENTATION**

**History of original corner establishment:**

Corner originally established by Timothy W. Davenport under GLO contract number 102, dated July 20, 1863. Surveyor General record states: Set post corner to Secs 35 & 36 on South side of spur of mountain course West, Made mound of rock.

Corner reestablished by Herman D. Gradon under GLO contract number 452, dated June 16, 1882. Surveyor General record states: Set a post 4 ft. long 4 ins square 24 ins in the ground for cor to secs 35 & 36 marked BL TIN R36 on N. S36 on E. and S35 on W. faces and raised a mound of stone around post. The old sec cor a post in mound of stone bears W. 1.50 chs dist. I destroy both post and mound.

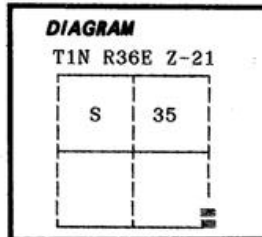

No record of subsequent monumentation found in Umatilla County survey records.

**Description of corner evidence found:**

Found a mound of stone, 4 ft. base  
1½ ft. high, with bits of wood in center.

See map of survey dated September, 1989.

**Description of monument and accessories I established to perpetuate the**

**original location of this corner:** In place of the mound of stone, I set a 2½" x 30" aluminum pipe with aluminum cap marked as shown, 6 inches in the ground, from which:

**New Bearing Objects:**

- A ½"x18" iron pin with plastic cap marked BGA SURVEY MARKER bears N60°E, 8.83 feet in small mound of stone.
- A ½"x18" iron pin with plastic cap marked BGA SURVEY MARKER bears N16°W, 9.10 feet in small mound of stone.

Set a steel fencepost approximately 5 feet East with Property Boundary and Land Survey Monument signs attached.

Raised a mound of stone around monument, 5 ft. base to top of cap.

I hereby certify that the above corner point was perpetuated as hereon described on August 14, 1989.

Witnesses: Rick Robinson and Jeff Petersen.

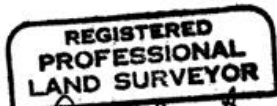

I used a steel tape and magnetic compass in the establishment of new accessories. I used 17° East magnetic declination.

Office of the Survey Dept. County of Umatilla  
 State of OR I hereby certify that the within instrument was filed in this office  
 for record on the 27<sup>th</sup> day of October, 1989.  
David B. Krambein by Kathleen Lamberty  
 (COUNTY OFFICIAL) (DEPUTY)

Form R6-7100-57 (9/71)

RECEIVED BY

\*GPO-591-971, 1988

Umatilla County Surveyor  
 Date 10-89  
 Rec'd by KA