

Form 874-9—Revised May, 1918

U. S. DEPARTMENT OF AGRICULTURE
FOREST SERVICE

Umatilla NATIONAL FOREST

CORNERS OF THE PUBLIC SURVEY

T. 1 N R. 36 E W Mer.

Section Corner common to Sections

16, 15, 21, and 22

Corner consists of a Stake (not) in place
State condition _____

Dimensions above ground _____ inches.

Sketch grooves, letters, figures, or notches, on proper face or edge.

CARDINAL POSITION

DIAGONAL POSITION

N	W	S	E

NW	SW	SE	NE

Mound of _____ is located _____

Pits are located _____

Sketch markings of Bearing Trees (or Rocks) in proper box and fill blanks below, giving bearings from Corner to Trees and Distances in Lines

Stump

<u>1 N</u>
<u>R36 E</u>
<u>16</u>

<u>36 E</u>
<u>S 21</u>

<u>N</u>
<u>36 E</u>
<u>S 22</u>

<u>T 1 N</u>
<u>R36 E</u>
<u>S 15</u>

BT

BT

BT

BT

Species

YP

DF

DF

YP

Diameter

4.0

24

24

26

Bearing

N 25 W

S 40 W

S 70 E

N 18 E

Distance

1/2 ch

1/2 ch

1 ch

3/4 ch

Do you believe this to be a genuine Land Office Corner? Yes

If not, why? _____

Donald J. Timmer
Signature.

May 12-29
Date.

Forest Ranger
Title.

T. 1 N R. 36 E Mer.

8-3027

(Make sketch of topography near Corner.)

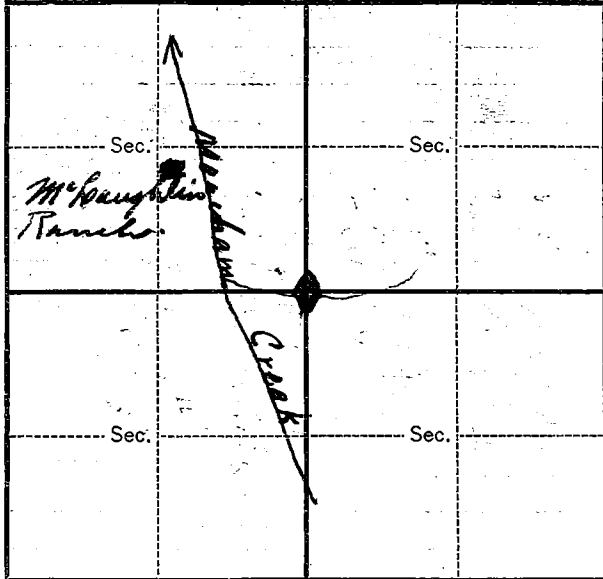

Metal Location Poster is on a Y.P.
tree 40 inches diameter, on the N.W.
side of corner.
from which this Corner bears S 55 E
1/2 chains distant.

Give any further facts which will aid in finding this
Corner again.

About 1/4 mile east of Michem
Creek, up a small canyon, the
post on south of Mt. McNaughton
Ranch on east side of Michem
Creek. Corner in bottom of canyon
two witness trees on each side.

Form 874-9—Revised May, 1918

U. S. Department of Agriculture
FOREST SERVICE

Utah NATIONAL FOREST

CORNERS OF THE PUBLIC SURVEY

T. 1 N. R. 36 E. W. Mer.

Section 15, 16, 21, and 22
Corner common to Sections

Corner consists of a small fir tree in place
State condition

Dimensions above ground _____ inches.
Sketch grooves, letters, figures, or notches, on proper face or edge.
CARDINAL POSITION DIAGONAL POSITION

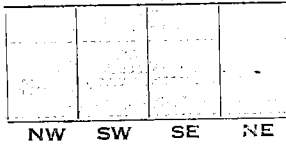
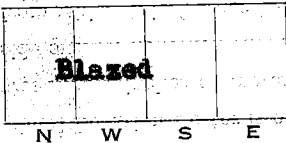

Mound of _____ is located _____

Pits are located _____

Sketch markings of Bearing Trees (or Rocks) in proper box and fill blanks below, giving bearings from Corner to Trees and Distances in Links.

T1N R36E S16 BT	T1N R36E S22 BT	36E S21 BT	T1N R36E S15 BT
--------------------------	--------------------------	------------------	--------------------------

Species	PPSnag	DFSnag	DFstump	PPdown tree
Diameter	42"	24"	34"	26"
Bearing	NW	SE	SW	NE
Distance	75	30'	40'	20'

Do you believe this to be a genuine Land Office Corner? yes

If not, why? _____

Paul Stewart
(Signature)

District Forest Ranger
(Title)

4/13/40
(Date)

T. _____ R. _____ Mer.
1 N. 36 E. 4 N.
(Make sketch of topography near Corner)

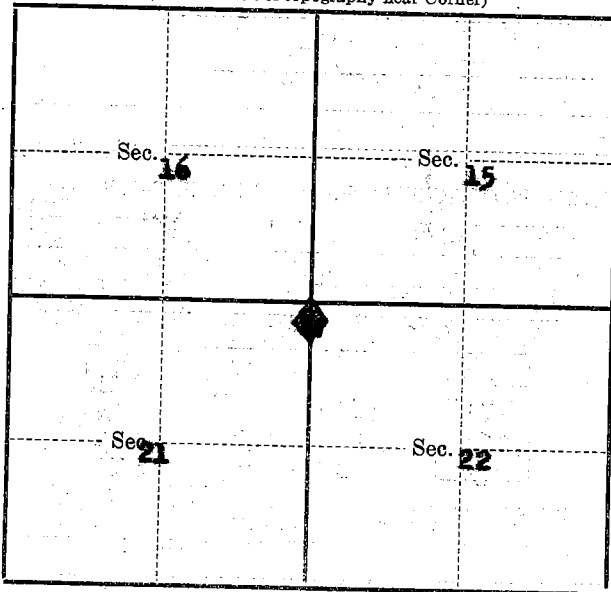

Metal Location Poster is on a the big pine snag
tree _____ inches diameter, on the bearing tree.
side of _____
from which this Corner bears _____
_____ chains distant.

Give any further facts which will aid in finding this
Corner again.

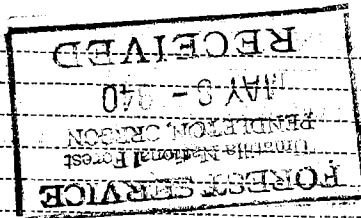

LAND CORNER RECORD

LL 5680-2

1. T. 1N R. 36E No. N-13 Cor. Sec. Mer. Will State Oregon (Rectangular) N. F. Uma Hila Dist. Paul 6

2. Corner Status

3. Original Description Vol. 281 Page 467 Where Recorded BLM

4. Description of Corners: A stone 24x18x8 18" in ground.

<u>A pine 22" dia</u>	<u>N15E</u>	<u>31 lbs</u>
<u>A Fir 18" "</u>	<u>S25E</u>	<u>85"</u>
<u>A " 28" "</u>	<u>S35W</u>	<u>87"</u>
<u>A Pine 40" "</u>	<u>N80W</u>	<u>48"</u>

5. Investigation Notes:

Found a pine 40" dia N55W 1/2 ch (Metal Tag)?

" " Fir 24" " S60W 1/2 ch (stump)

" " " 24" " S70E 1 ch ?

" " Pine 26" " N18E 3/4 ch (dead)

All trees show scumbing

All bearing trees dead by April 13, 1940.

Do not fit original notes: T&H 3/75

7. Photo Identification

Photo No. _____
Ident. By: _____

8. Plane Coordinate Position Data

State _____ Zone _____

X _____

Y _____

Estab. By _____

Field Book No. _____

Where Filed _____

9. Evaluation

Authentic _____

Needs Verif. X Monument NO

Re-estab. _____ Survey _____

Land Status _____

6. Signed G. Tucker Title D. R. Date May 12, 1929

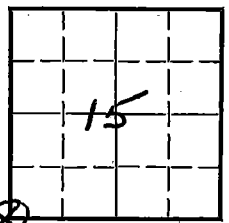

PERPETUATION RECORD

10. Monument:

11. Accessories

Field Book _____ Page _____

12. Set By _____ Title _____

13. Recorded By _____ Volume _____ Page _____

(Agency)

License _____ Agency _____ Date _____

(Date) _____ (City) _____ (County) _____ (State) _____

14. Remarks:

N-13