

OREGON CORNER RESTORATION FORM

COUNTY: Umatilla DATE: Maintained 7/28/94. Revisited October 2001, no changes from 1994 corner certificate except for new GPS co-ordinate, which is shown on this certificate.

CORNER DESIGNATION: Z-25. Southeast corner Section 36, T1N., R35E., W.M.

PREVIOUS RENEWALS/SURVEYS, ETC.: Record by James P. Currin and James Noland, under Special Contract dated May 4, 1887 states: "Cor. is a post 4 1/2 ft. long, 4 ins. square set firmly in the ground marked S.C.T.1 N. on N.; S31R36E on E., and S36R35E on W. faces with 6 notches on N.E. and W. edges, from which: A Spruce, 8 ins. in diam. bears N 30 E 31 lks. dist., marked S.C.T.1N.R.36E.S31 B.T. A Pine, 14 ins. in diam. bears N15°W.37 lks. dist., marked S.C.T.1 N.R.35E.S36 B.T. A Pine, 12 ins. in diam. bears S.50°W.32 lks. dist., marked S.C.T.1 S.R.36 E.B.T." Reference to corner and accessories by Currin and Noland refer to original corner record by Timothy Davenport under Contract No. 102, dated July 20, 1863. Corner recovered by BLM in 1983, records state: "The standard cor. to T. 1 N., Rs. 35 and 36 E., determined at record distance from the original bearing trees: A spruce, 24 ins. diam., bears N. 17° E, 31 lks. dist., with scribe marks R36 visible on opened blaze and healed lower blaze. (Record, N. 60° E.) A fir, 14 ins. diam., bears N. 60° W., 37 lks. dist., with scribe marks BT visible on opened lower blaze and healed upper blaze. (Record, pine, N. 15° W.) At the corner point Set an iron post, 28 ins. long, 2 1/2 ins. diam., 24 ins. in the ground, with brass cap (marked as shown in monument detail). from which a new bearing tree A fir, 28 ins. diam., bears N. 79° W., 52 lks. dist., mkd. T1N R35 E S36 SC BT."

MONUMENT AND ACCESSORIES FOUND:

A 3 1/4" brass cap (BLM) on 2 1/2" galvanized iron pipe, protruding 6" out of ground, (marked as shown in monument detail).

Bearing Trees:

- A 24" uprooted douglas fir bears N 17° E-20.2 feet, (Davenport bearing tree).
- A 14" white fir bears N 60° W-24.4 feet, 2 foot stump, 'BT' visible, (Davenport bearing tree).
- A 30" douglas fir bears N 79° W-33.8 feet, scribed, pitched over, (BLM bearing tree).

MONUMENT MARKING DETAIL:

U.S. DEPT INT.
 SC
 T1N
 R35E R36E
 S36 | S31

 1983
 B L M

Accessories:

- Witness sign is attached to existing steel fence post 3.3 feet North of monument.
- A 29" ponderosa pine bears N 79° E-59.3 feet, scribed: T1N R36E S31 SC BT.
- A 12" tamarack bears N 52° W-62.8 feet, scribed: T1N R35E S36 SC BT.
- A 5/8" iron rebar with yellow plastic cap stamped "OR PLS 1106-WA PLS 17372", bears N 48° E-16.6 feet.
- Bearing object sign is attached to iron rebar. A steel fence post is set near iron rebar with witness sign attached. Bearing trees have a brass washer stamped 'PLS 1106' nailed to the face of the blaze.
- Bearing object and witness signs are attached to bearing trees.

LOCATION & COMMENTS:

STATE PLANE CO-ORDINATE:

Oregon North Zone, NAD 83/91, International Foot:
N = 681034.92
E = 8747334.56

COMPASS DECLINATION: 18° East.

Surveyor's Seal

FIRM/AGENCY: William R. Wells, PLS
P.O. Box 1696
Pendleton, Oregon 97801

Party Chief: Jason M. Wells, LSIT
Witness: Mark Hammersla
1N35Z25

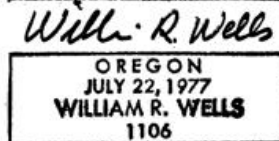
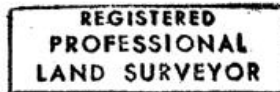

RECEIVED BY
Umatilla County Surveyor
Date 11-01
Rec'd By KK

renews 6-30-02